



PGDOM

---

INDUSTRIAL

TECHNICAL  
CATALOG



PGDOM  
INDUSTRIAL

# CONTENTS

- 4 Types of systems
- 5 Types of muntin bars
- 6 Types of grips
- 8 Handle height
- 9 Handle types
- 10 Sliding doors - wall mounting
- 11 Sliding doors loft art - wall mounting
- 12 Sliding doors - with fix
- 13 Sliding doors - with fanlight and fix
- 14 Sliding doors set
- 15 Sliding doors - hidden cassette
- 16 Hinge door
- 18 Hinge door set
- 19 Double hinge door
- 20 Double hinge door set
- 22 Pivot door
- 23 Folding door - without bottom rail
- 24 Folding door - with bottom rail
- 25 Fixed glass wall instalation
- 26 Hinge door instalation
- 27 Hinge door - with side panels and fanlight instalation
- 28 Corner glass wall - assembly
- 29 Glass types
- 30 Our projects - photos



# TYPES OF SYSTEMS

Loft 20

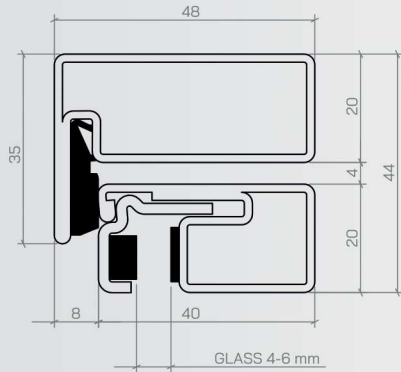

Loft 25

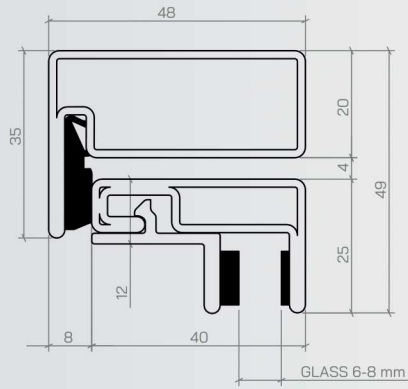

Loft 35

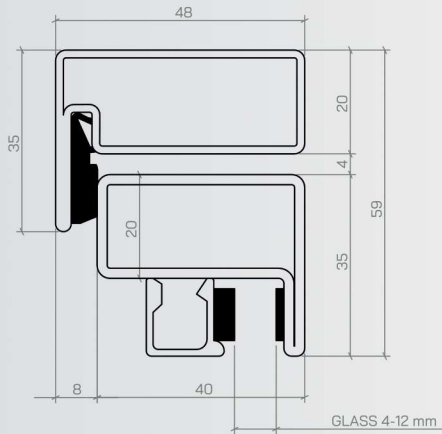

# TYPES OF MUNTIN BARS

Loft 20 glued bar 20 mm

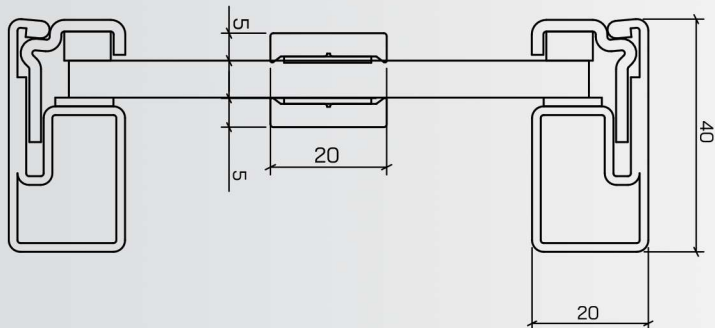

Loft 20 construction bar  
WELDED ONE SIDE

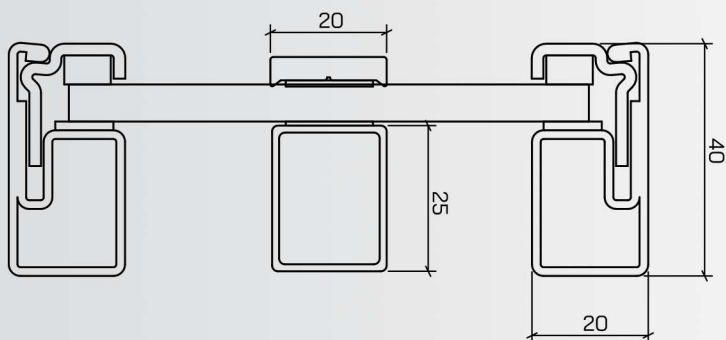

Loft 20 glued bar 40 mm

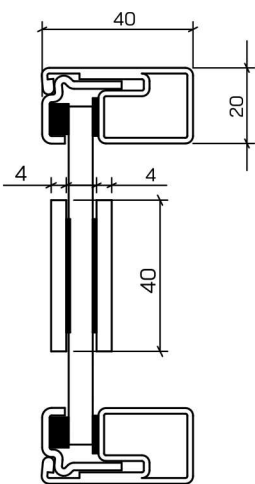

Loft 35 glued bar 20 mm

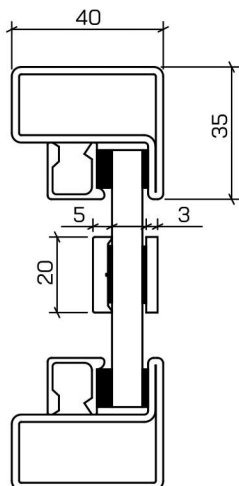

Loft 25 glued bar 20 mm

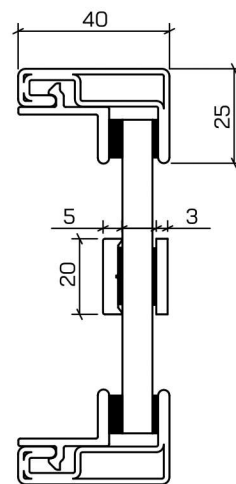

## ■ TYPES OF GRIPS

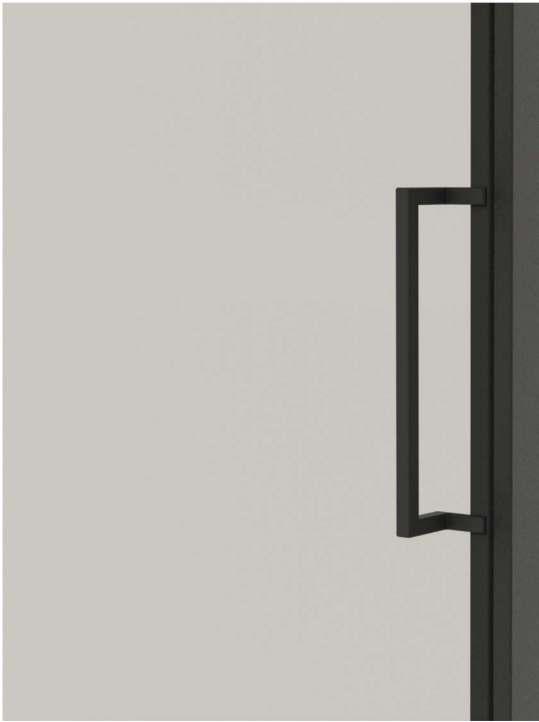

Premium mini (300 mm)



Premium (500 mm)



Standard 20 (200 mm)



Standard 50 (500 mm)

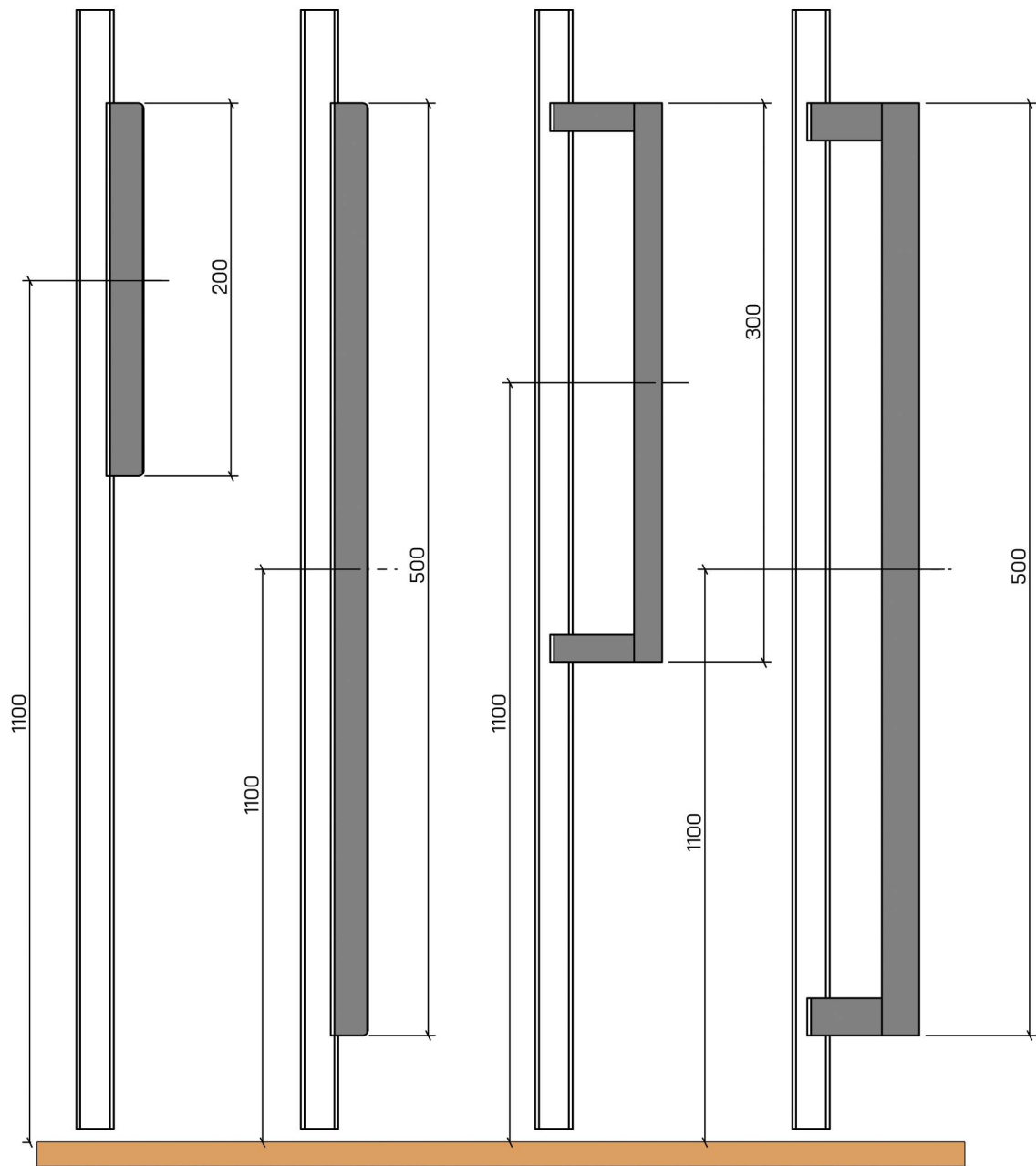

**Standard**

**Standard 50**

**Premium mini**

**Premium**

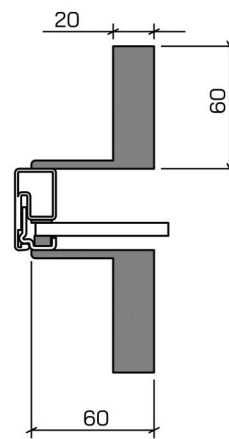
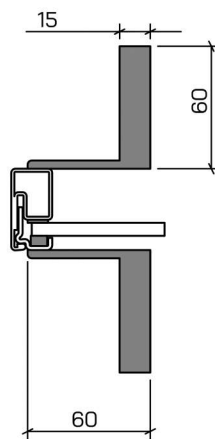
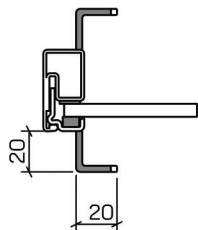
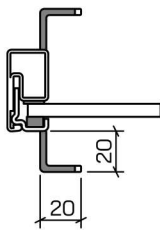

# HANDLE HEIGHTS

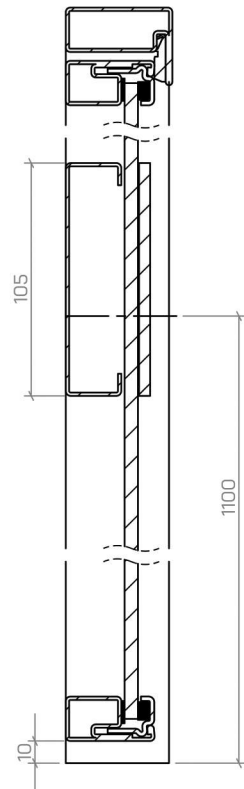
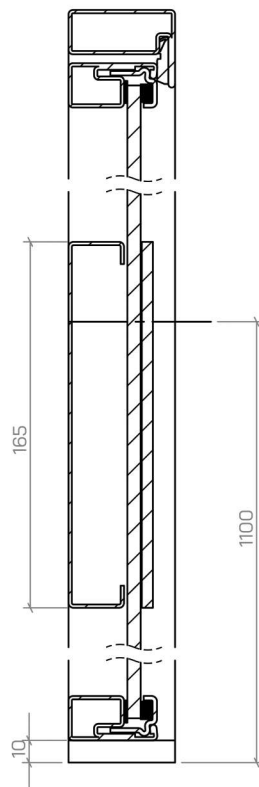
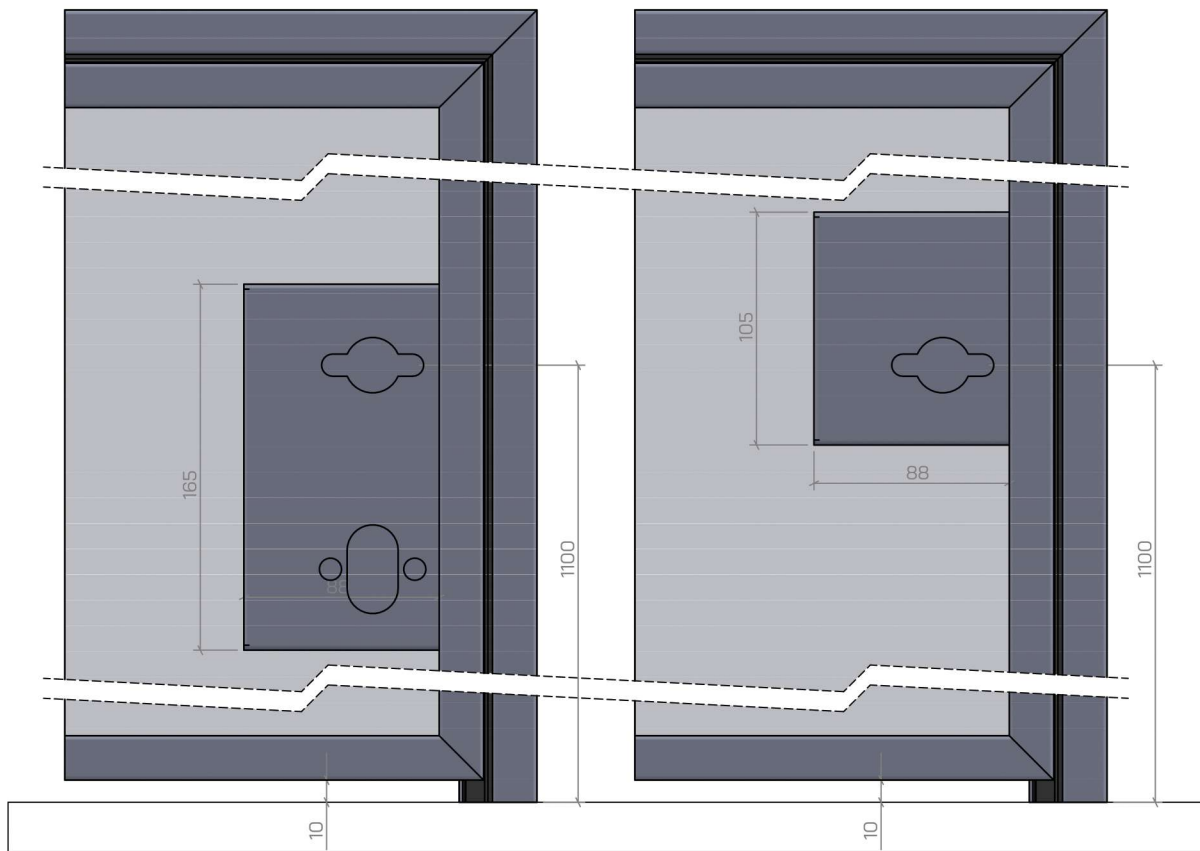



# HANDLE TYPES

Square handle  
BLACK, WHITE, INOX

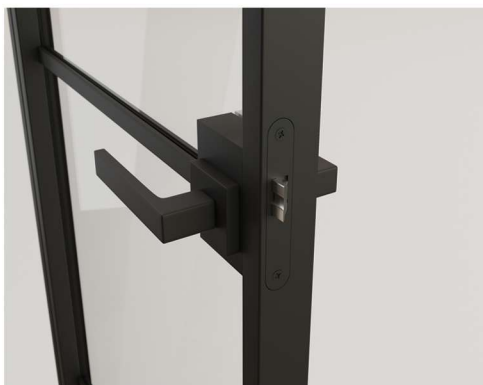

Square WC handle  
BLACK, WHITE, INOX



Square handle with lock  
BLACK, WHITE, INOX



LOFT Handle



MODERN handle



Round handle  
BLACK, WHITE, INOX



Round handle with lock  
BLACK, WHITE, INOX



Round handle WC with lock  
BLACK, WHITE, INOX



# SLIDING DOORS

wall mounting

Without distance

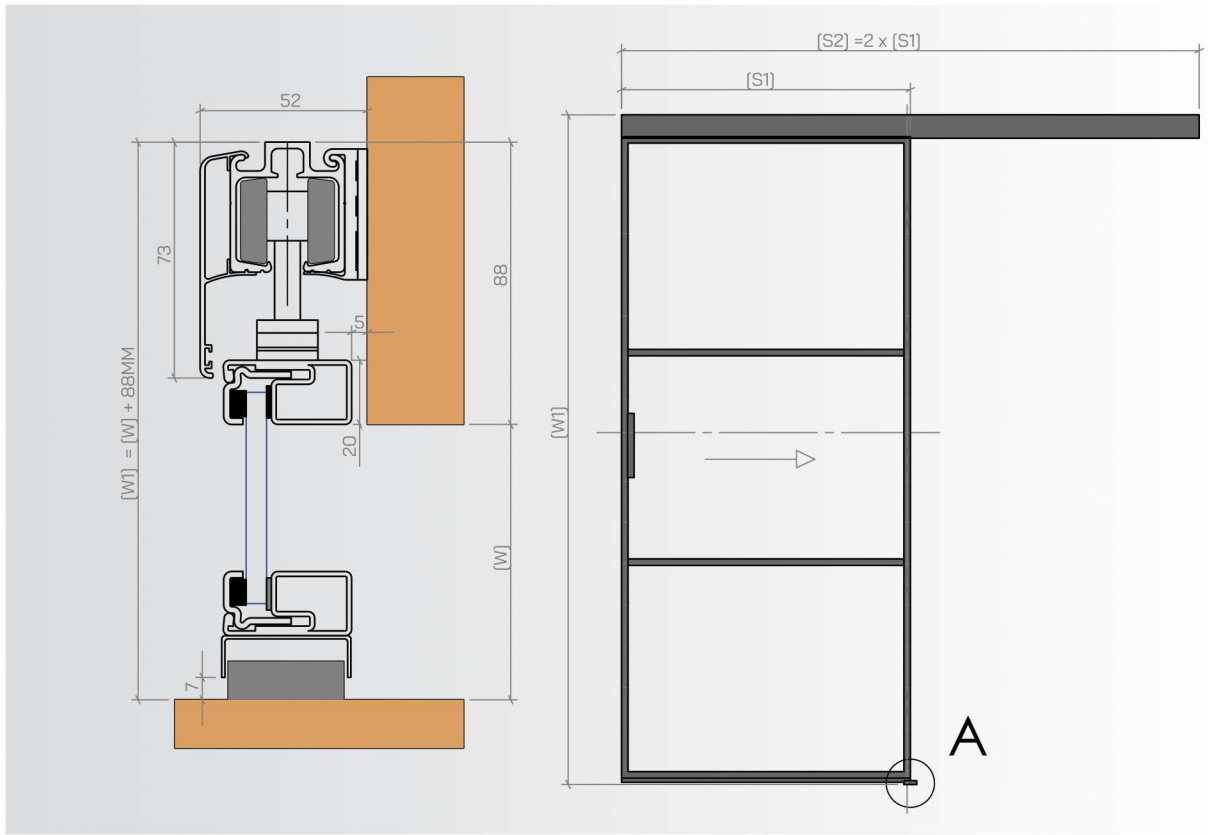

With distance

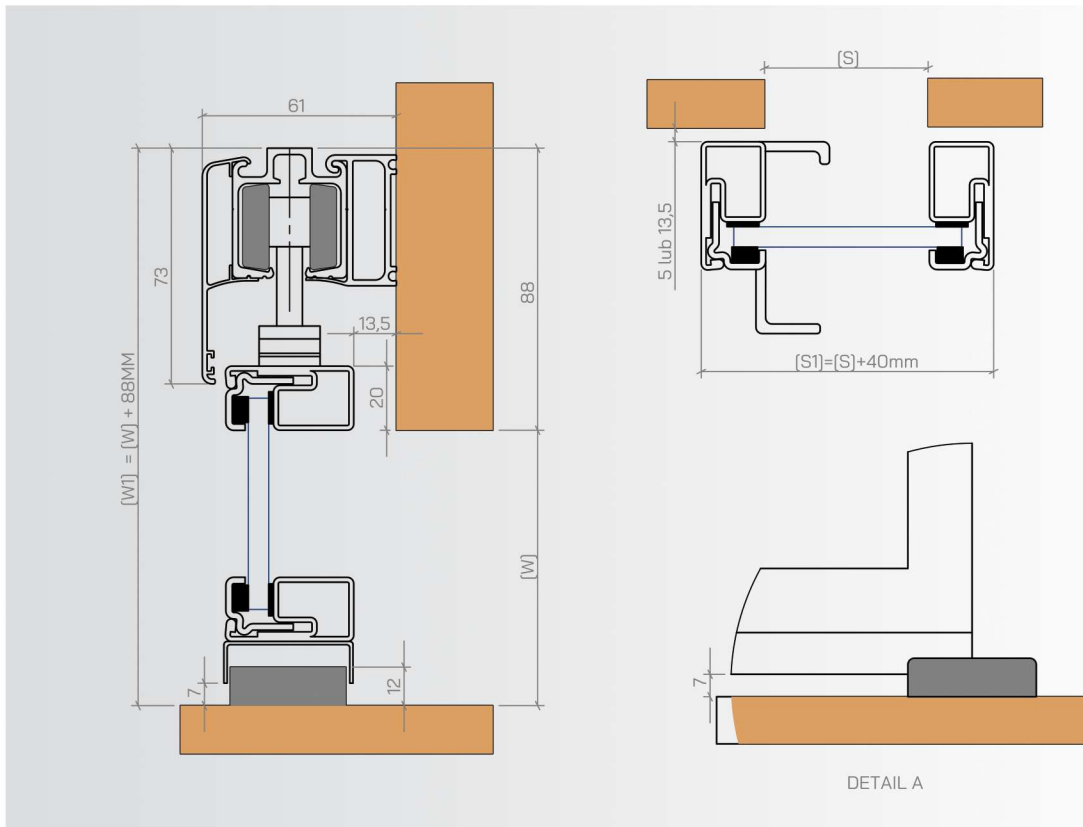

# SLIDING DOOR LOFT ART

wall mounting

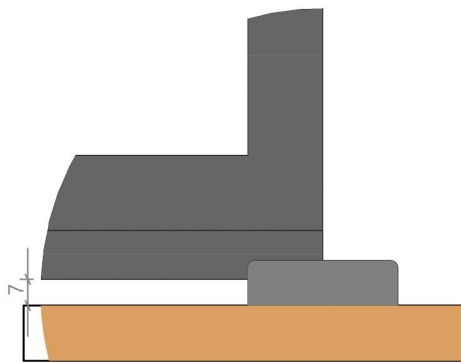
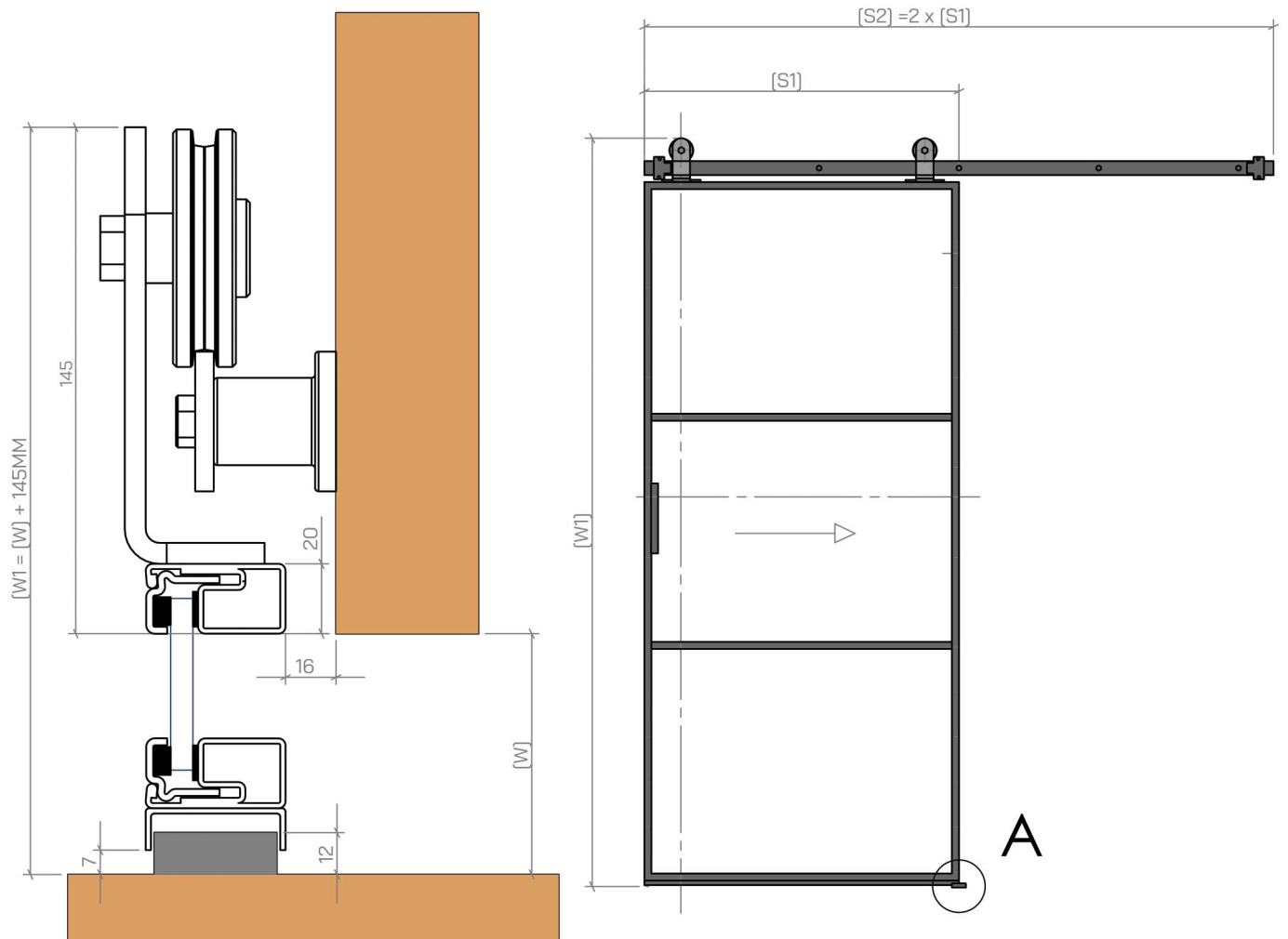

DETAIL A

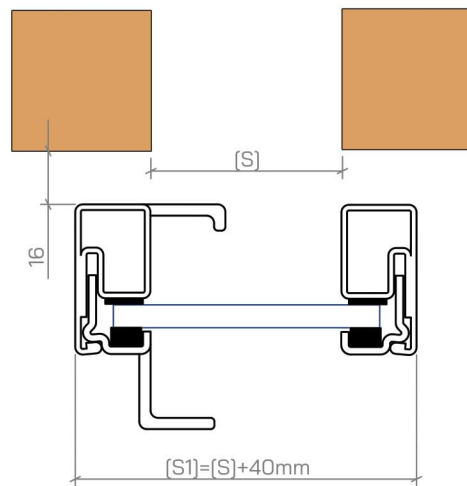

# SLIDING DOOR WITH FIX

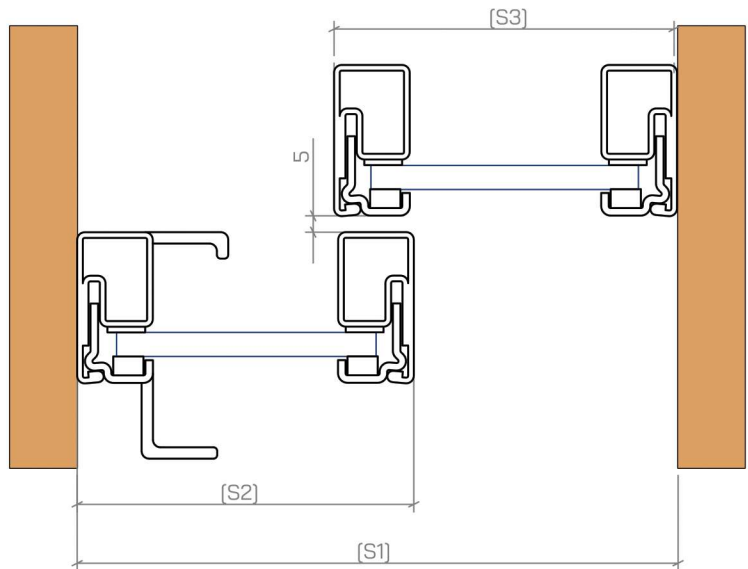
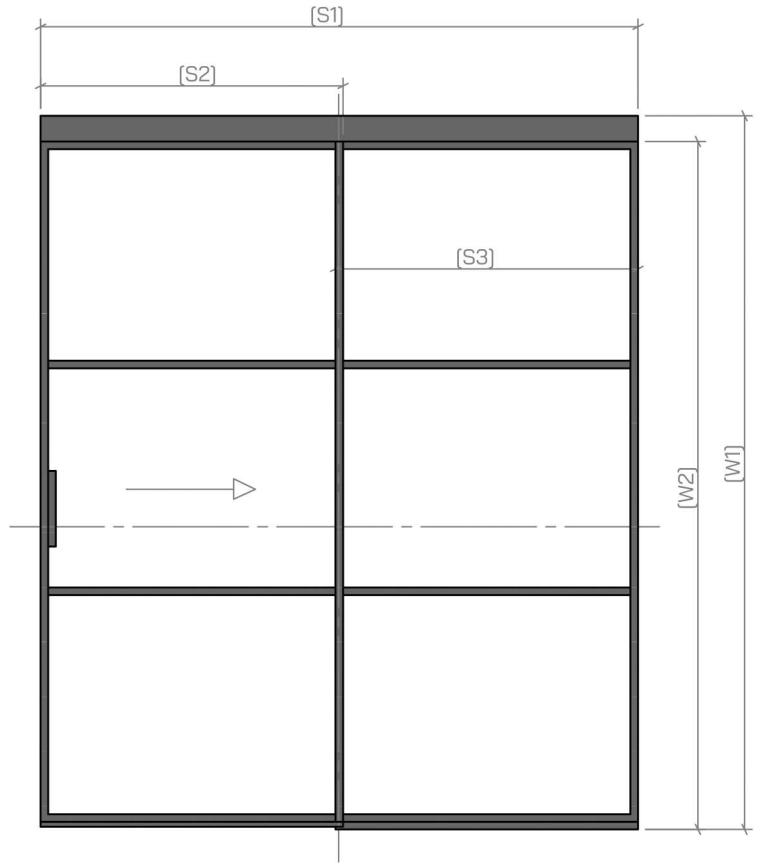
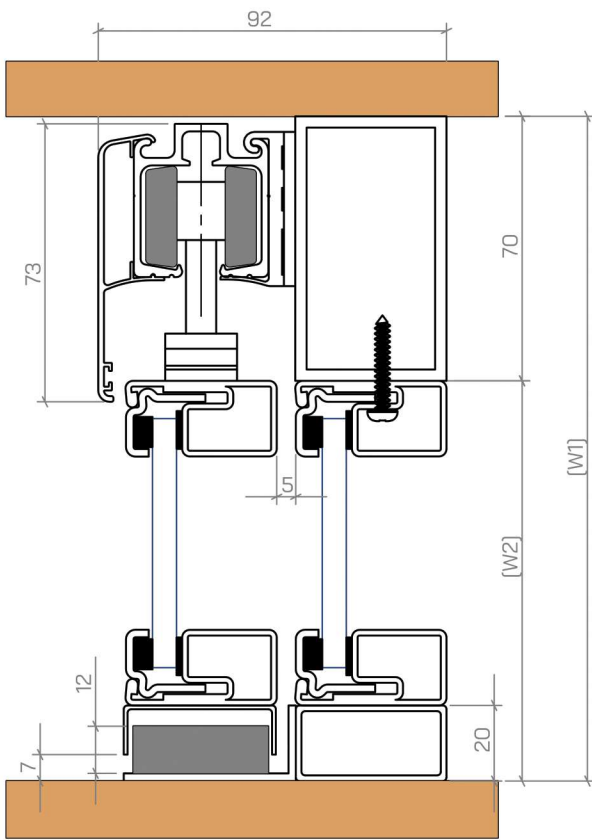

# SLIDING DOOR WITH FANLIGHT AND FIX

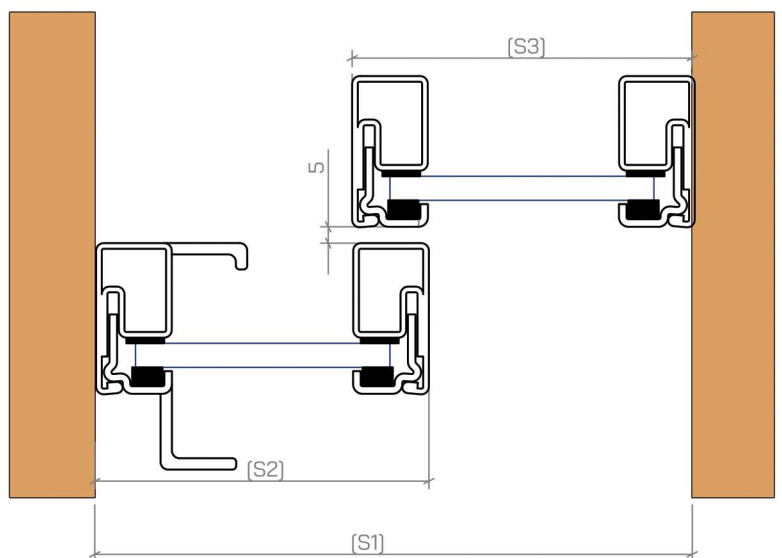
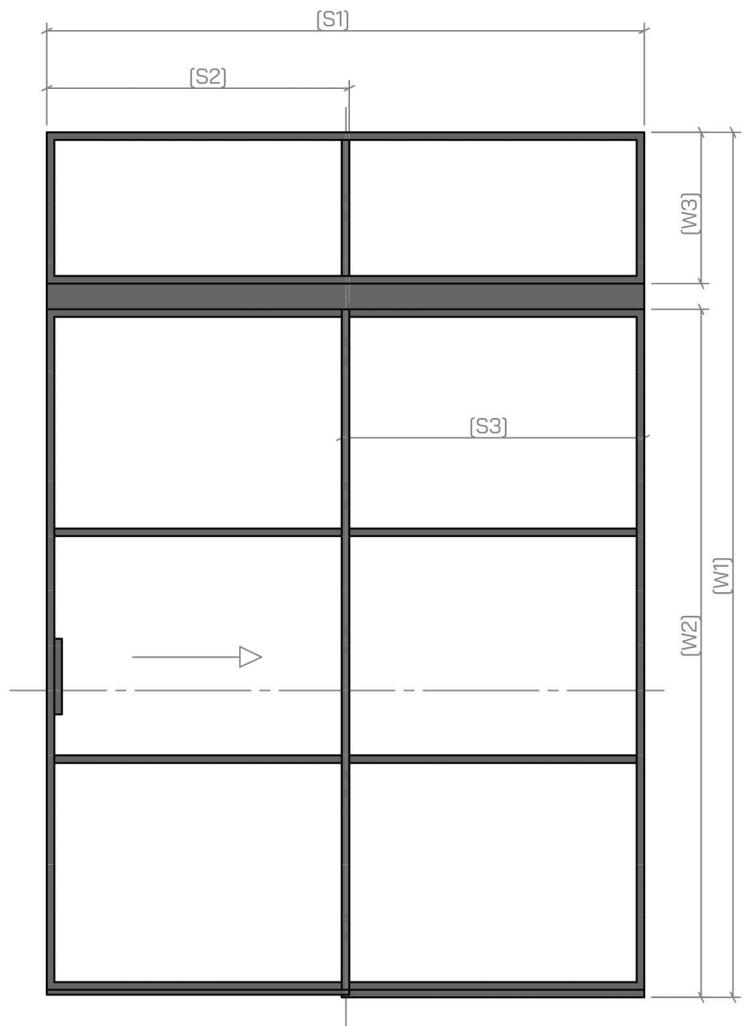
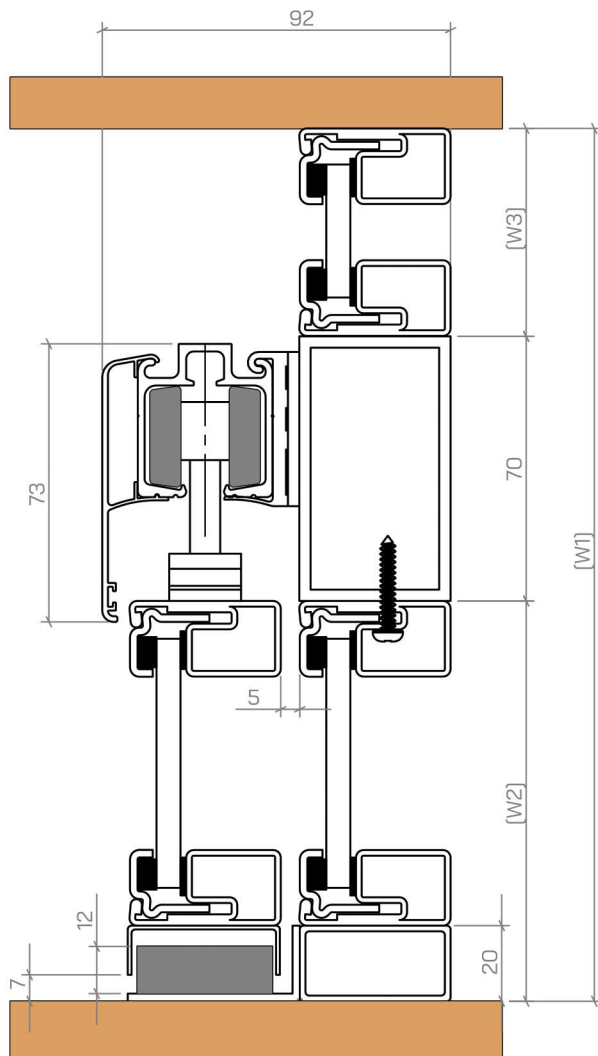

# SLIDING DOOR SET

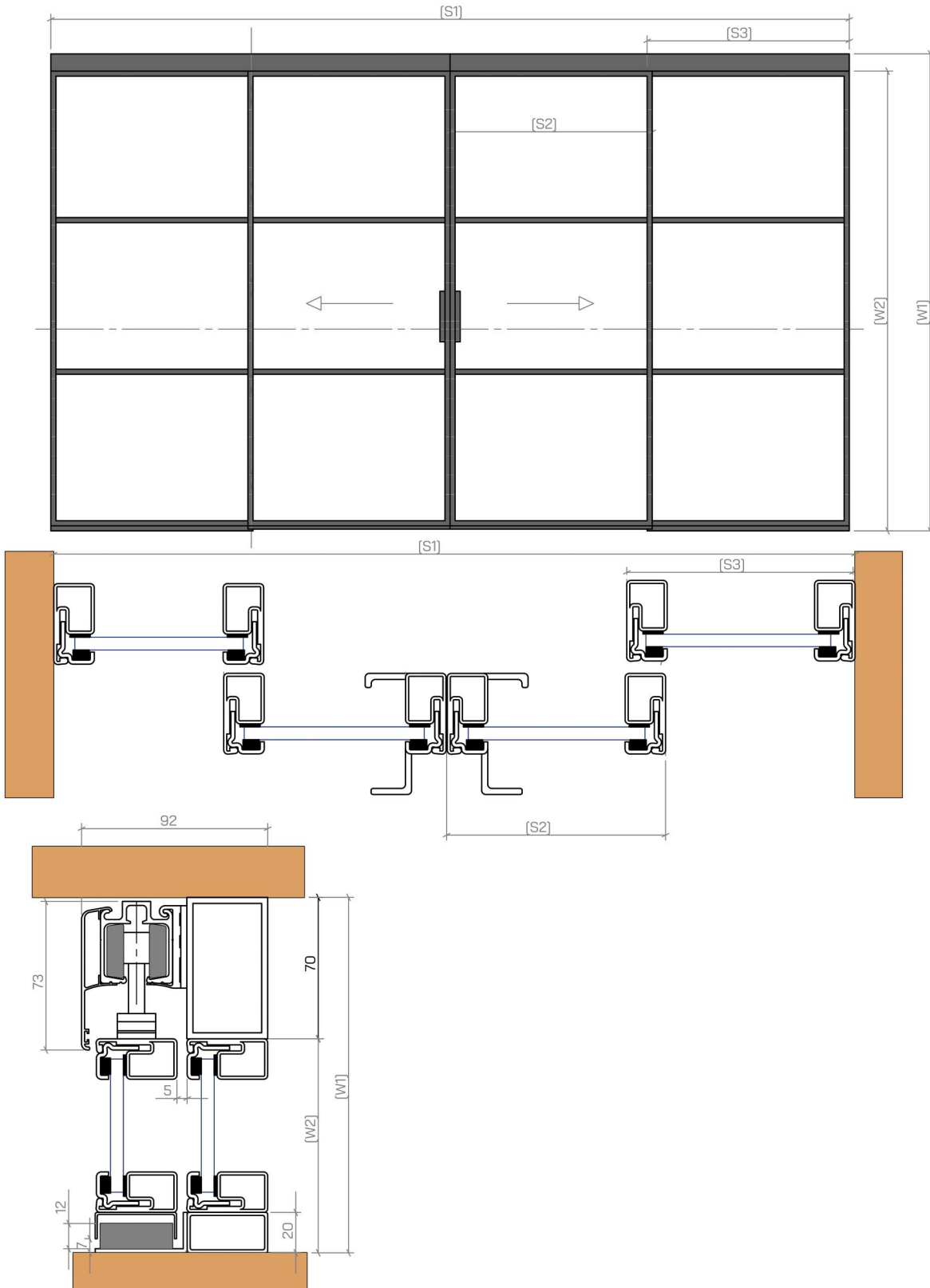

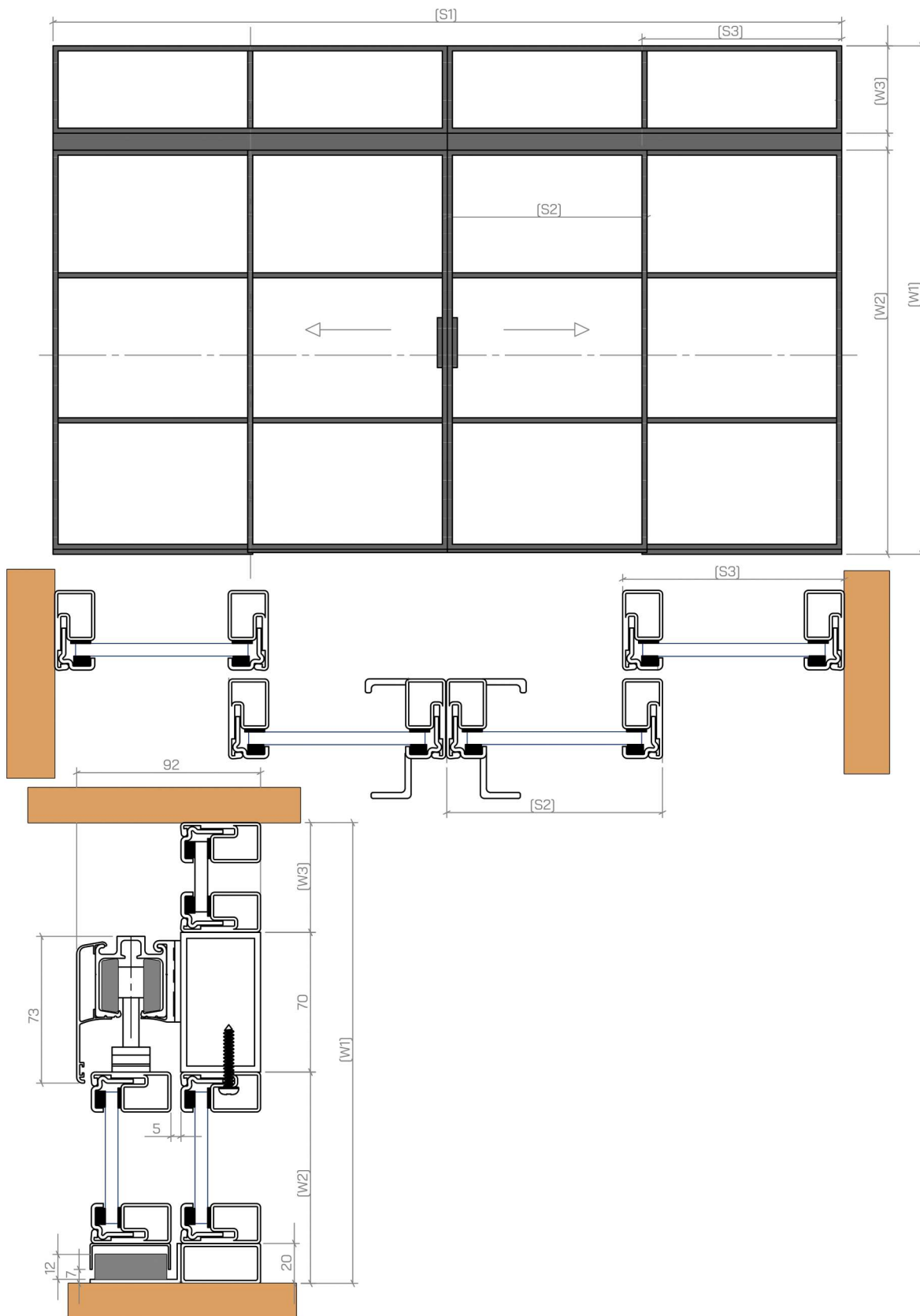

# SLIDING DOOR

hidden cassette

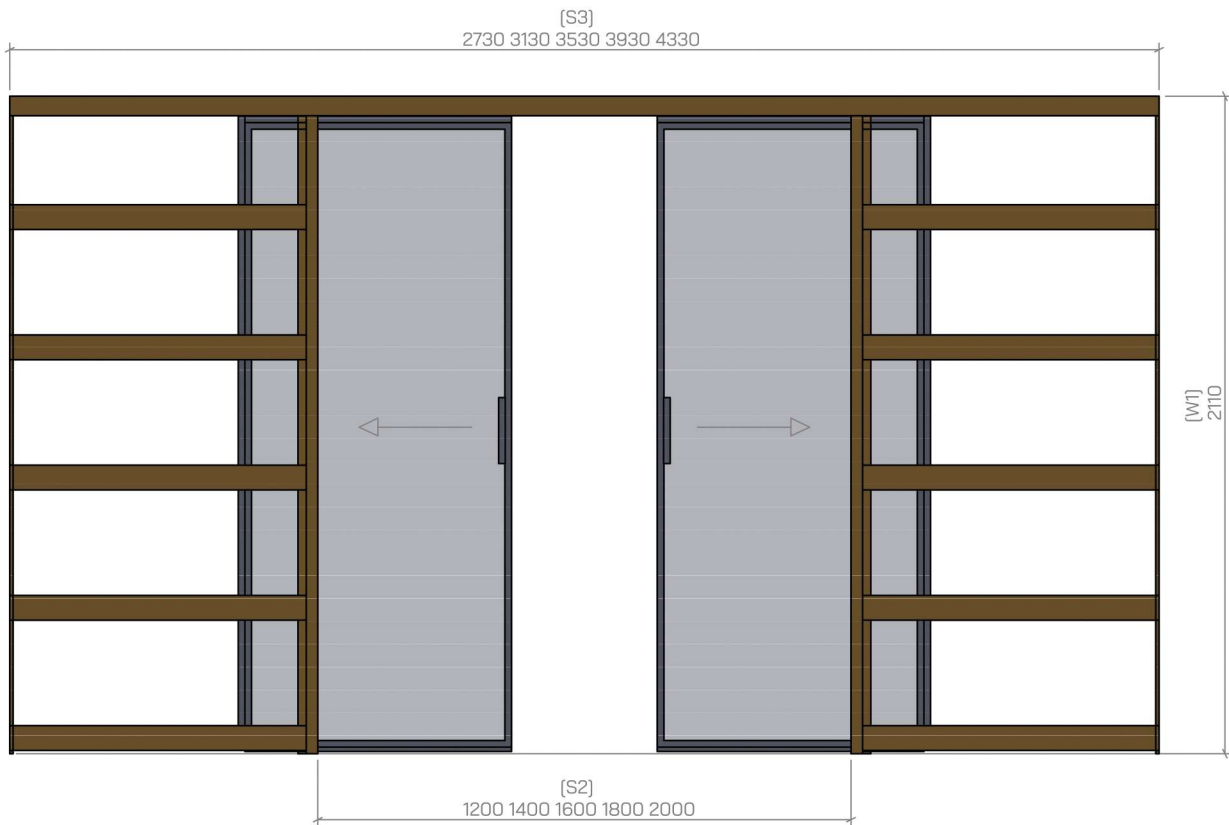
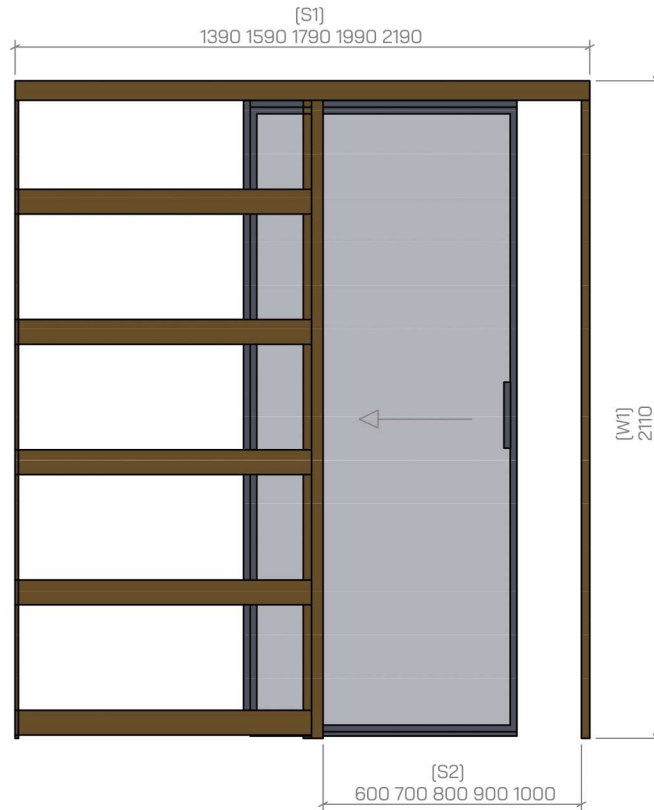



# HINGE DOOR

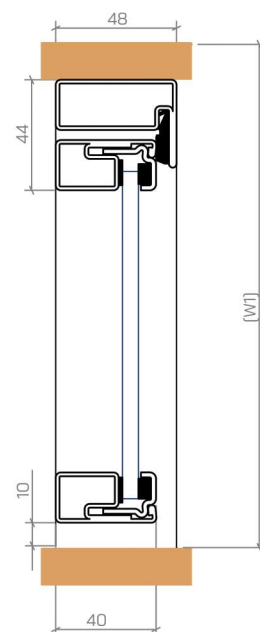
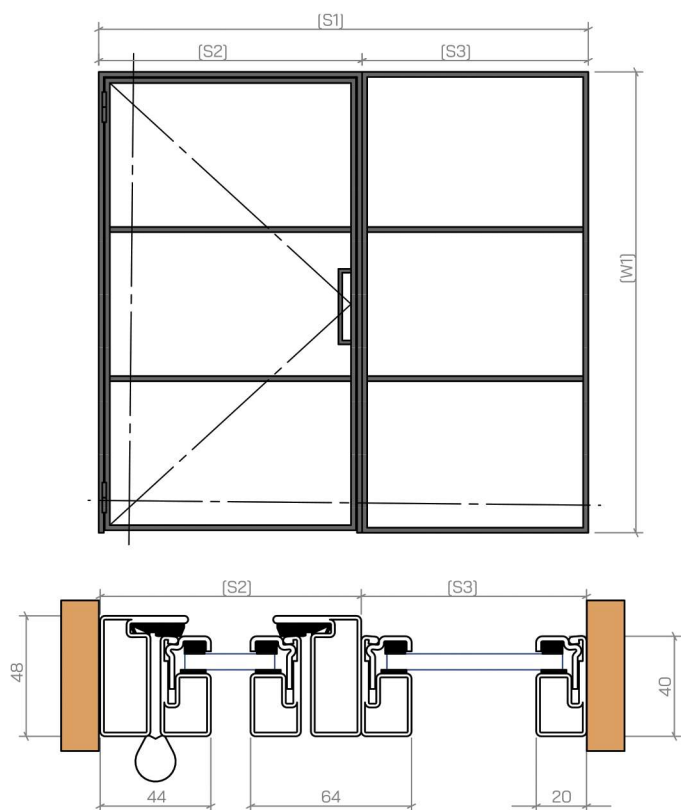
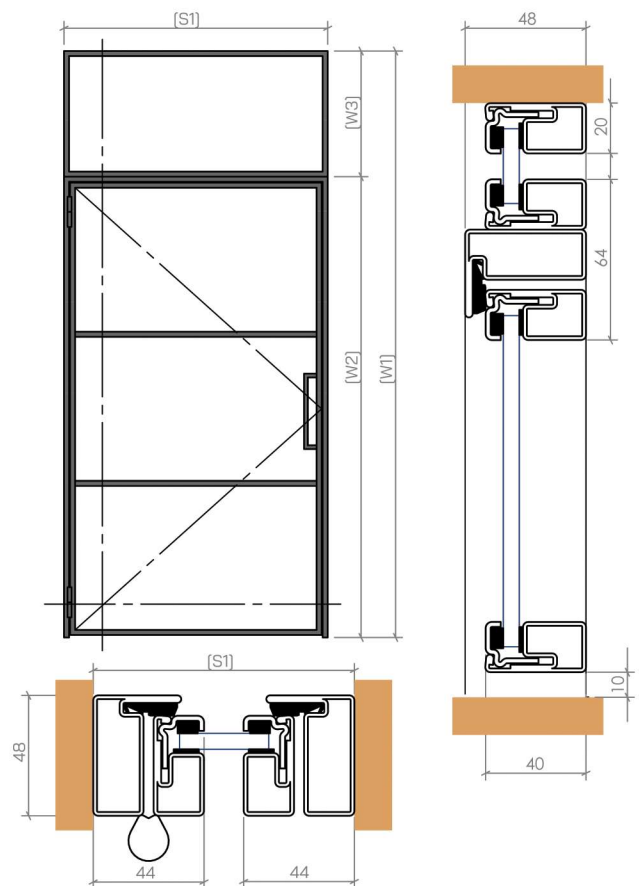
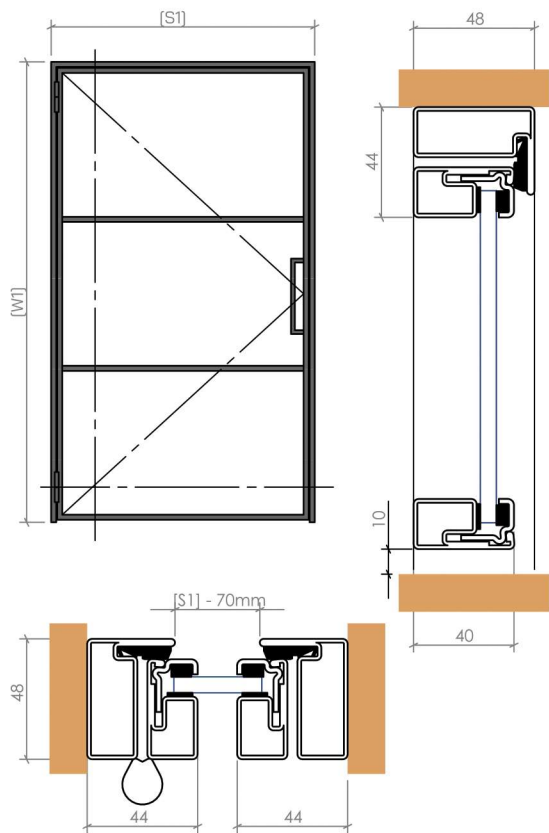

# HINGE DOOR SET

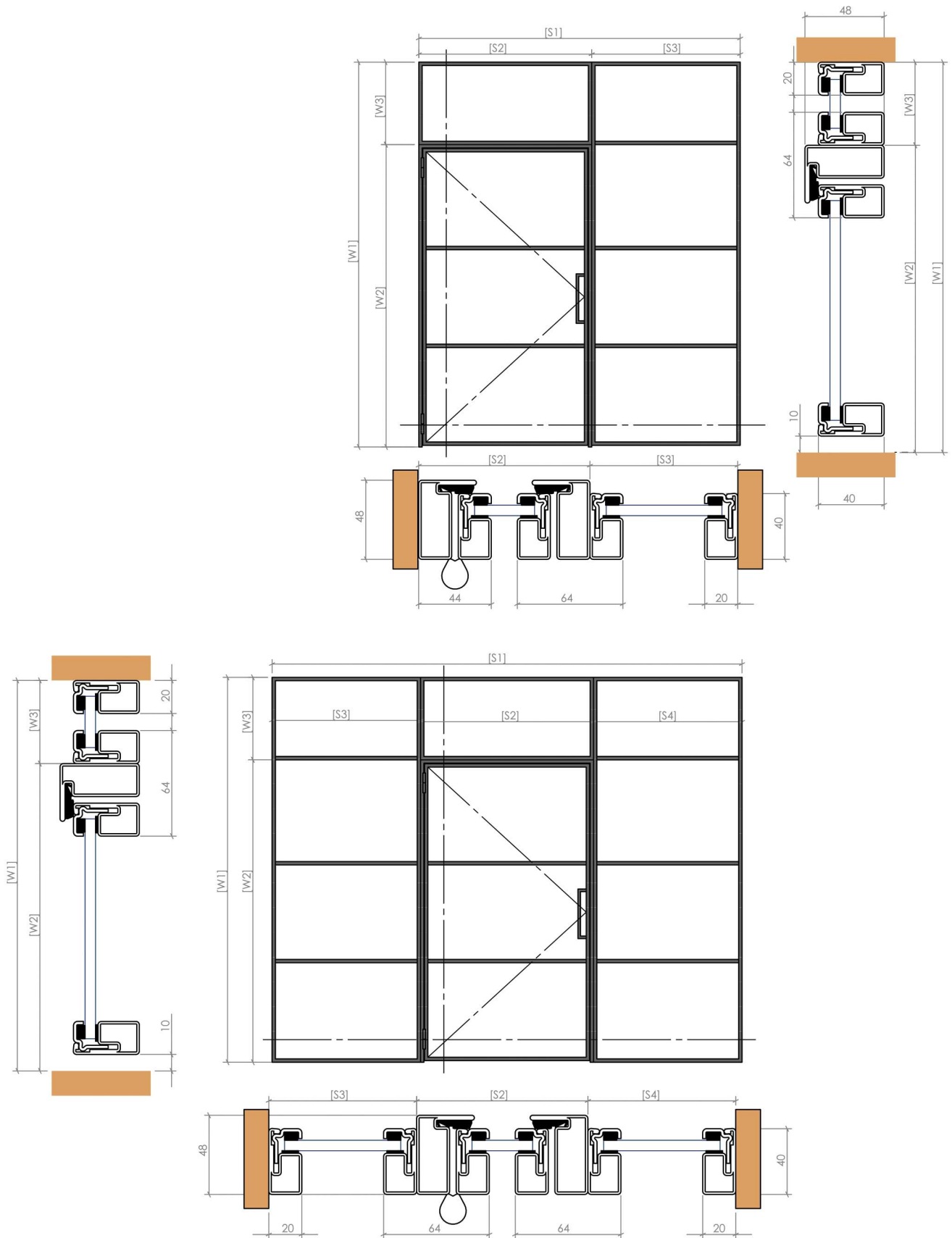

# DOUBLE HINGE DOOR

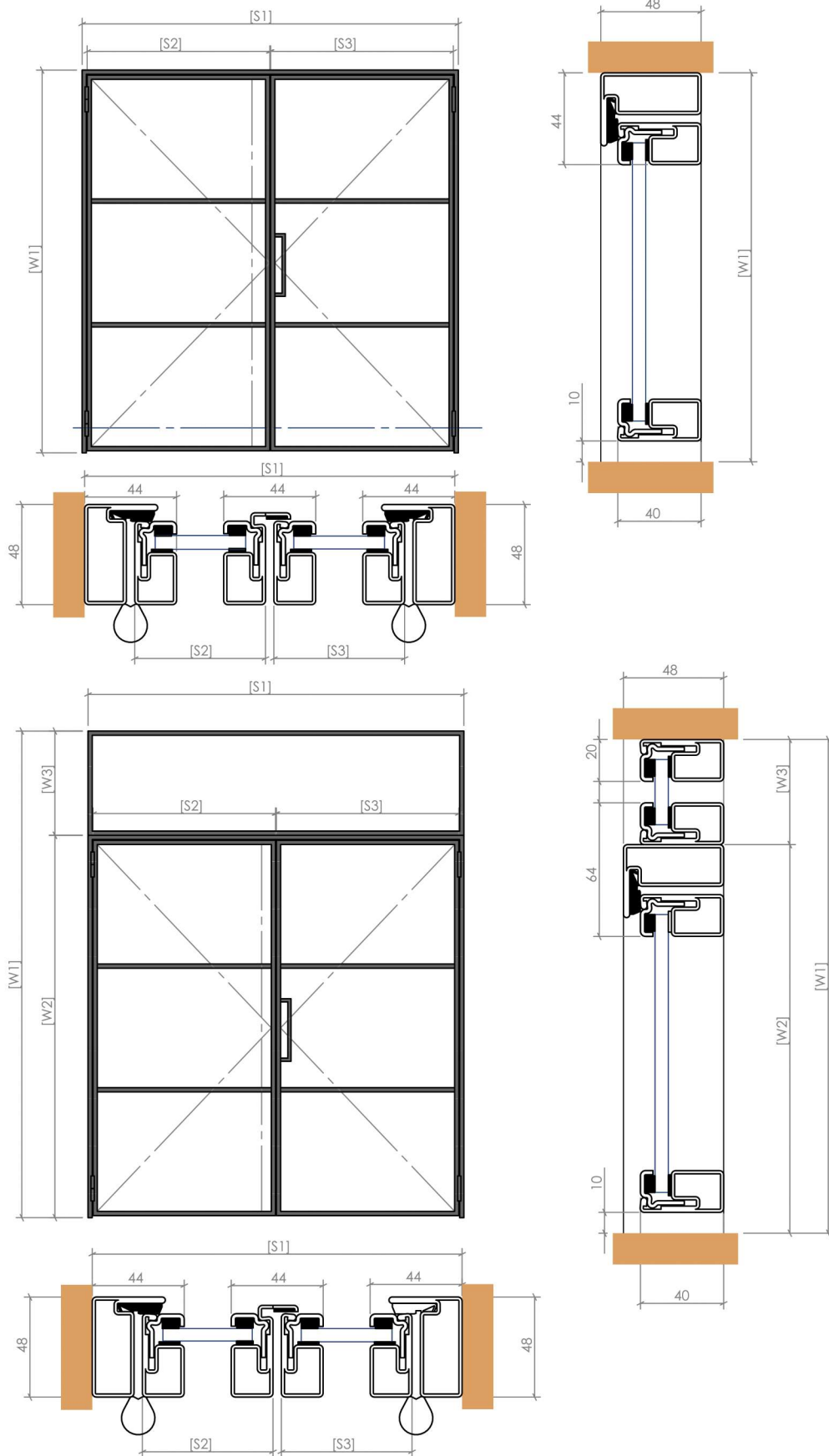

# DOUBLE HINGE DOOR SET

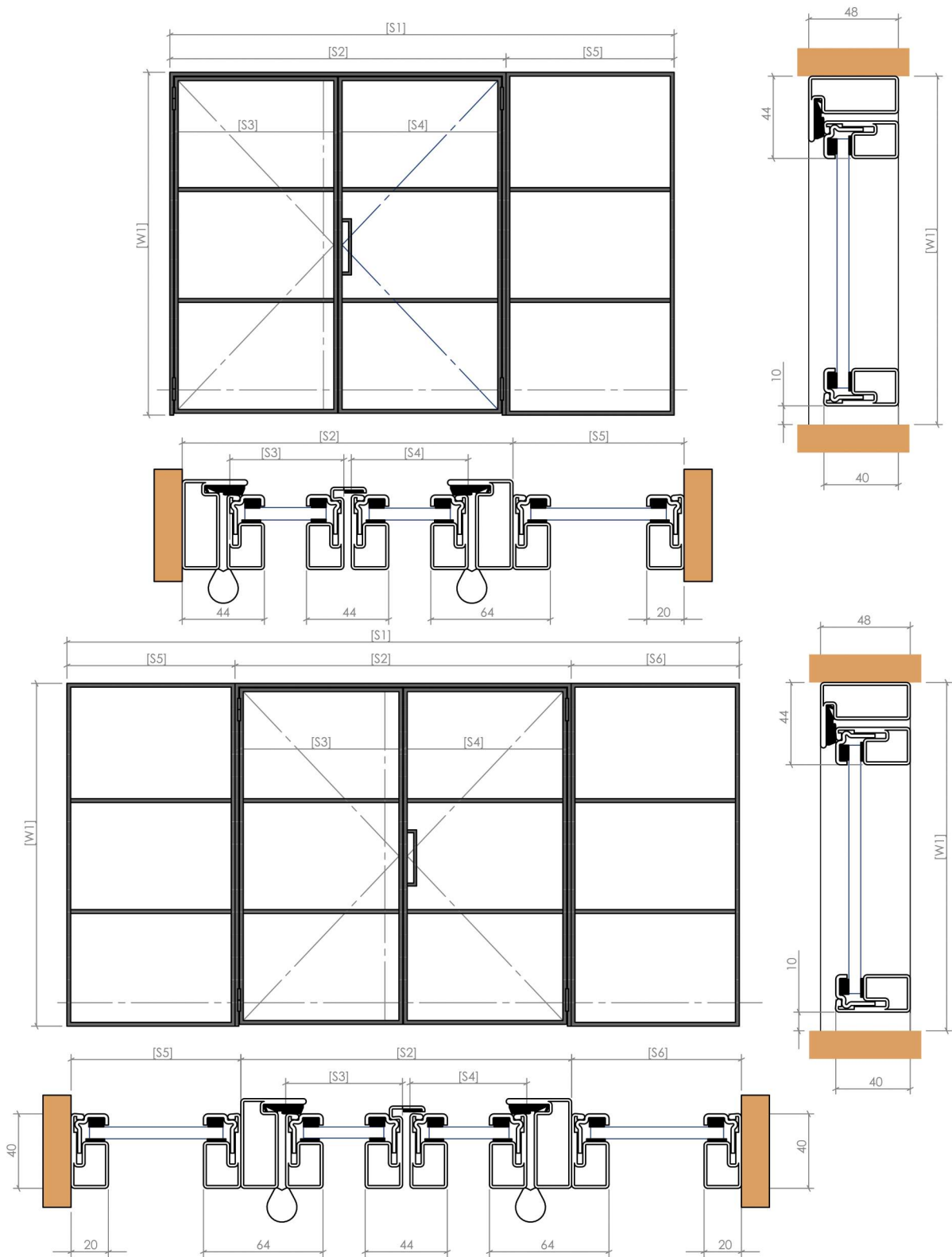

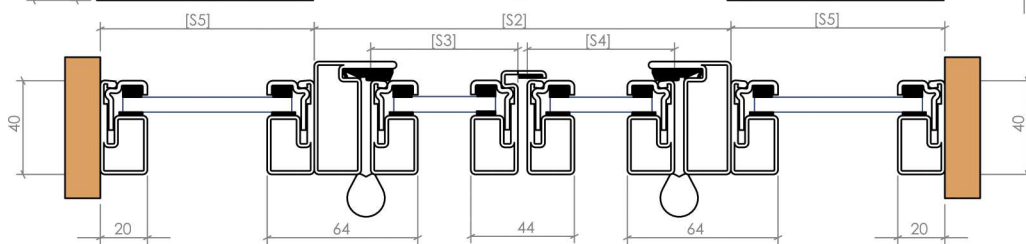
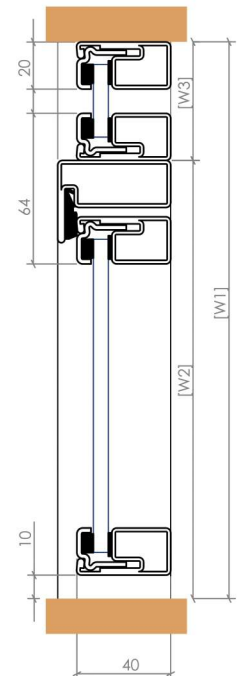
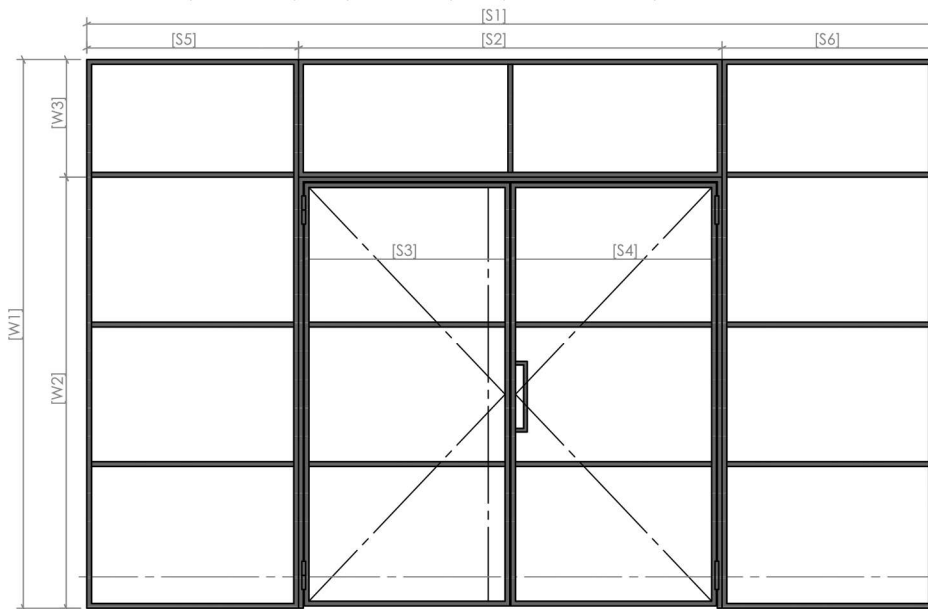
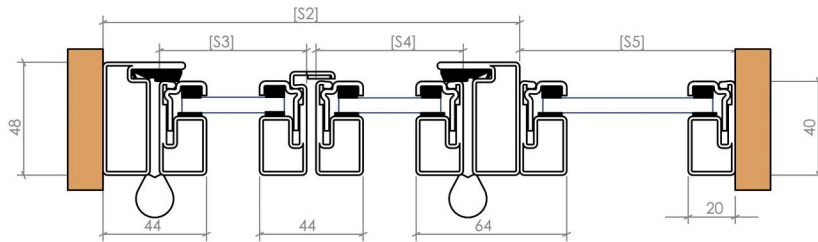
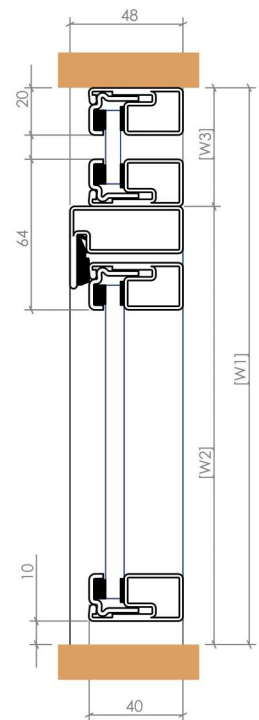
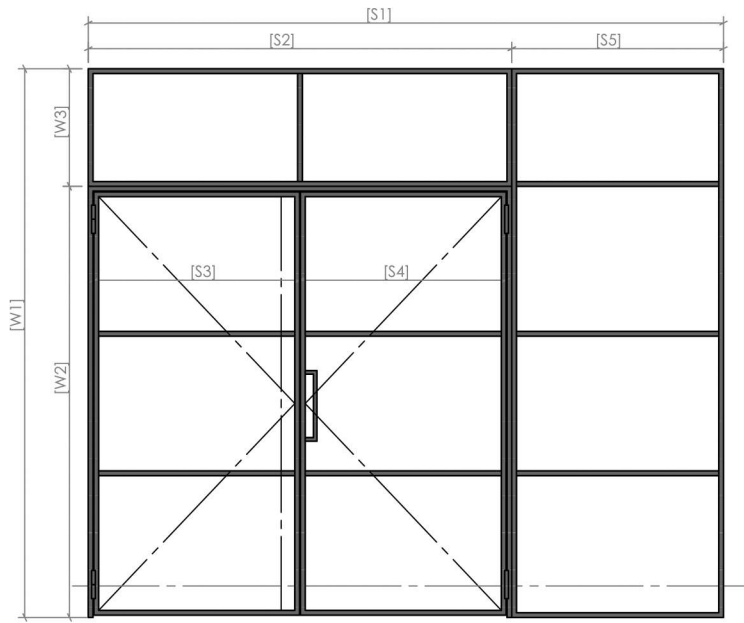

# PIVOT DOOR

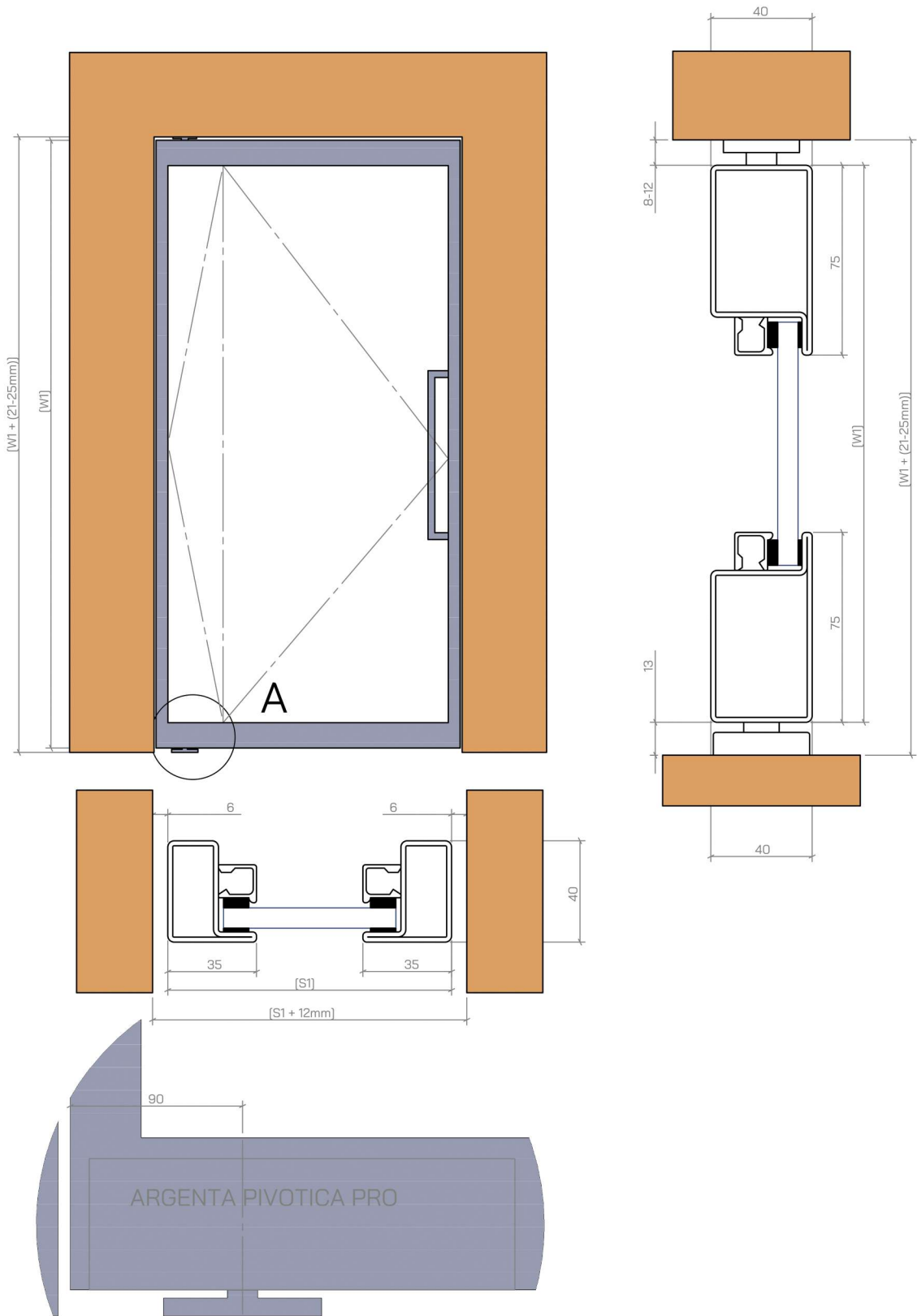

# FOLDING DOOR

without bottom rail

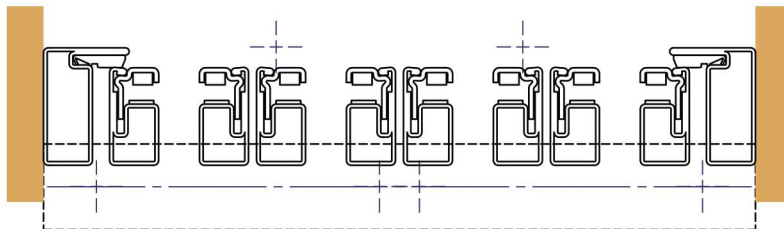
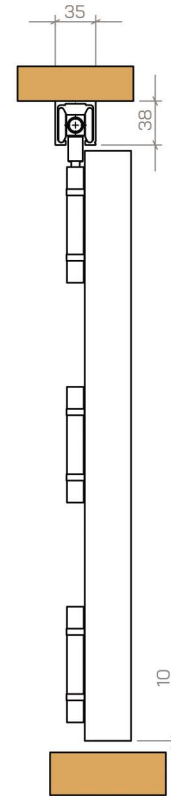
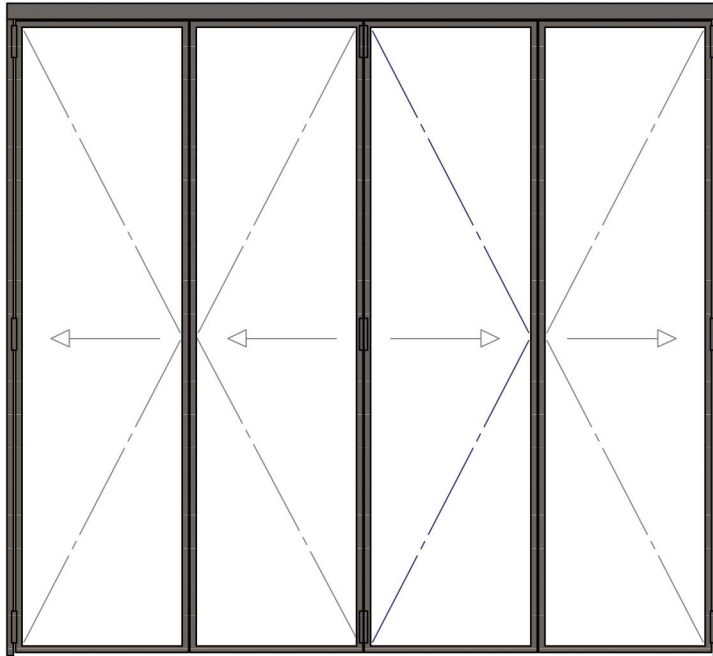

MAX: 40KG PER  
1 DOOR LEAF

## POSSIBLE SOLUTIONS

|       |  |       |  |
|-------|--|-------|--|
| 2L    |  | 1L 3P |  |
| 2L 1P |  | 1L 2P |  |
| 3L    |  | 1L 4P |  |
| 3L 1P |  | 4P    |  |
| 4L    |  | 3L 3P |  |
| 4L 1P |  | 4L 3P |  |
| 3L 2P |  | 3L 4P |  |
| 2P    |  | 2L 3P |  |
| 1L 2P |  |       |  |
| 3P    |  |       |  |

# FOLDING DOOR

with bottom rail

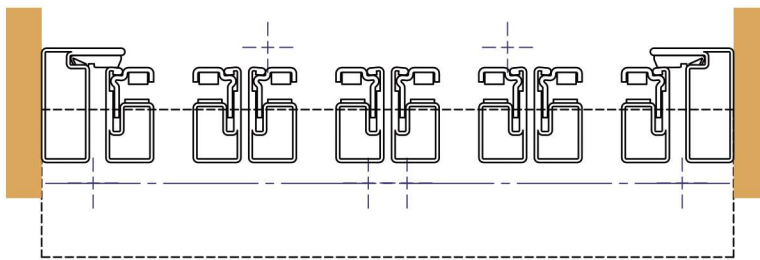
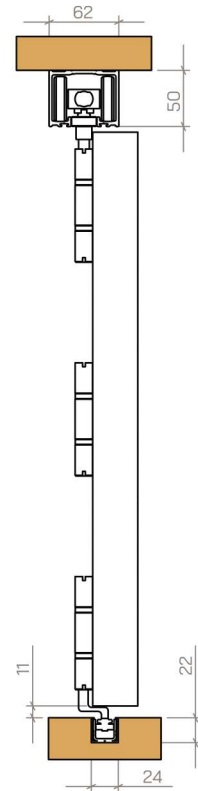
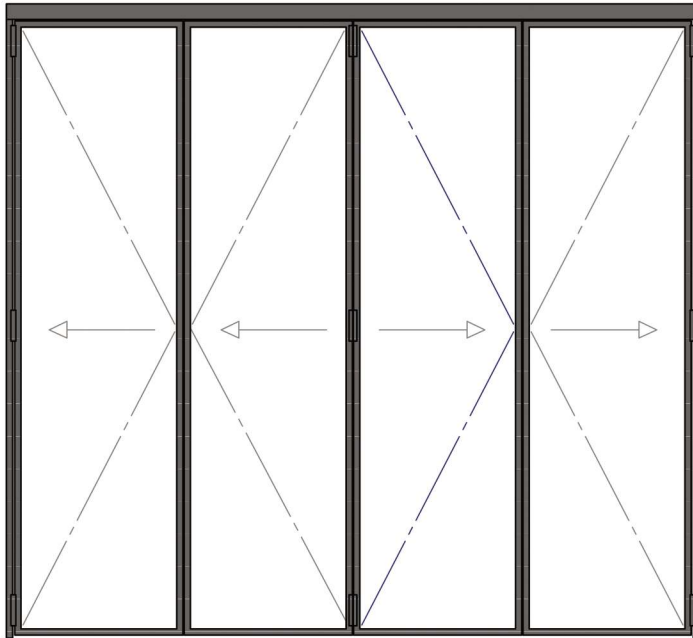

MAX: 100KG PER  
1 DOOR LEAF

## POSSIBLE SOLUTIONS

|       |  |       |  |
|-------|--|-------|--|
| 2L    |  | 5L    |  |
| 2L 1P |  | 3L 3P |  |
| 3L    |  | 7L    |  |
| 3L 1P |  | 4L 3P |  |
| 4L    |  | 5L 2P |  |
| 4L 1P |  | 5L 3P |  |
| 3L 2P |  | 2L 3P |  |
| 2P    |  | 5P    |  |
| 1L 2P |  | 3L 4P |  |
| 3L    |  | 7P    |  |
| 1L 3P |  | 2L 5P |  |
| 2L 2P |  | 8P    |  |
| 1L 4P |  |       |  |
| 4P    |  |       |  |



# FIXED GLASS WALL INSTALATION

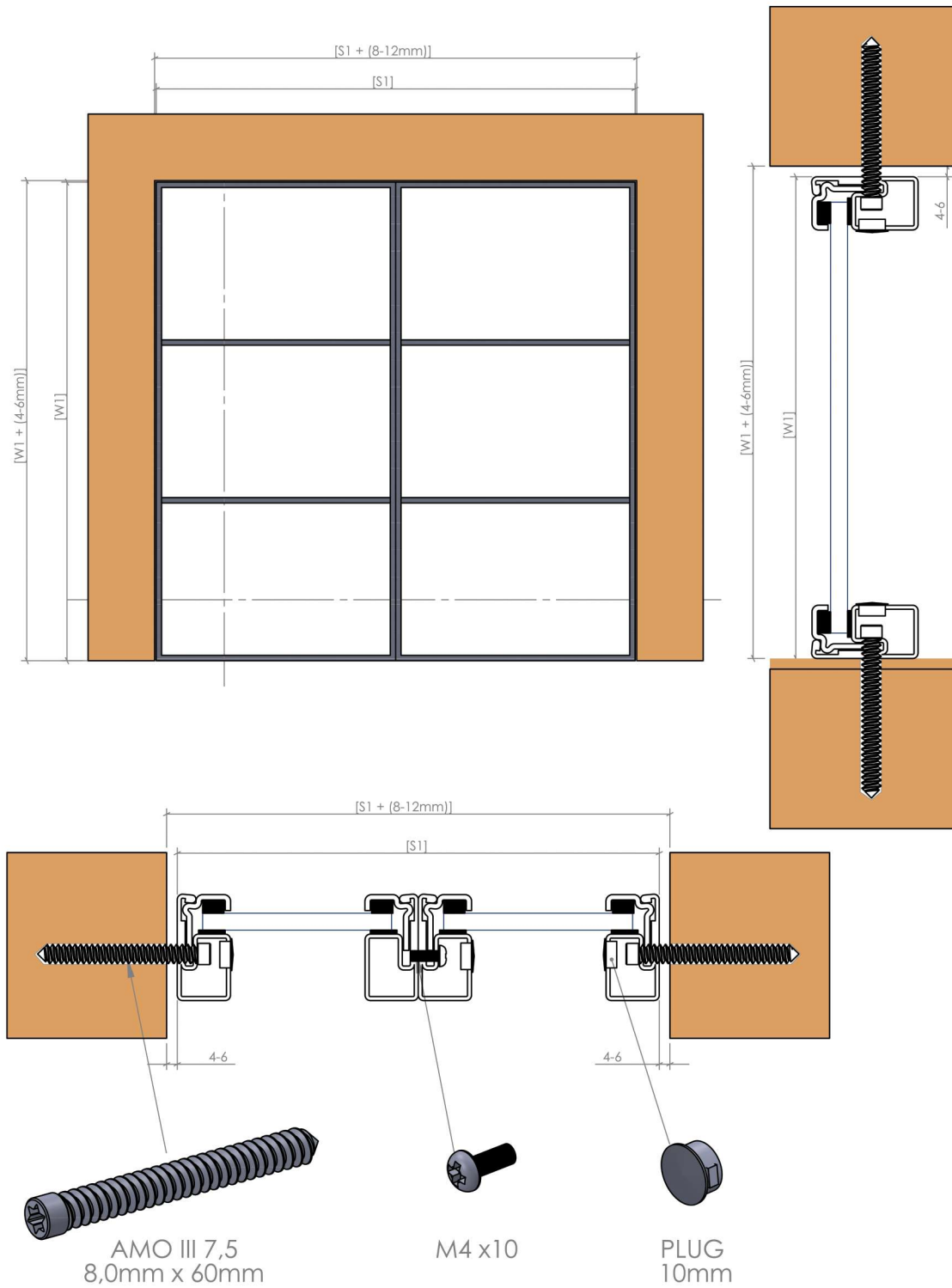

# HINGE DOOR INSTALATION

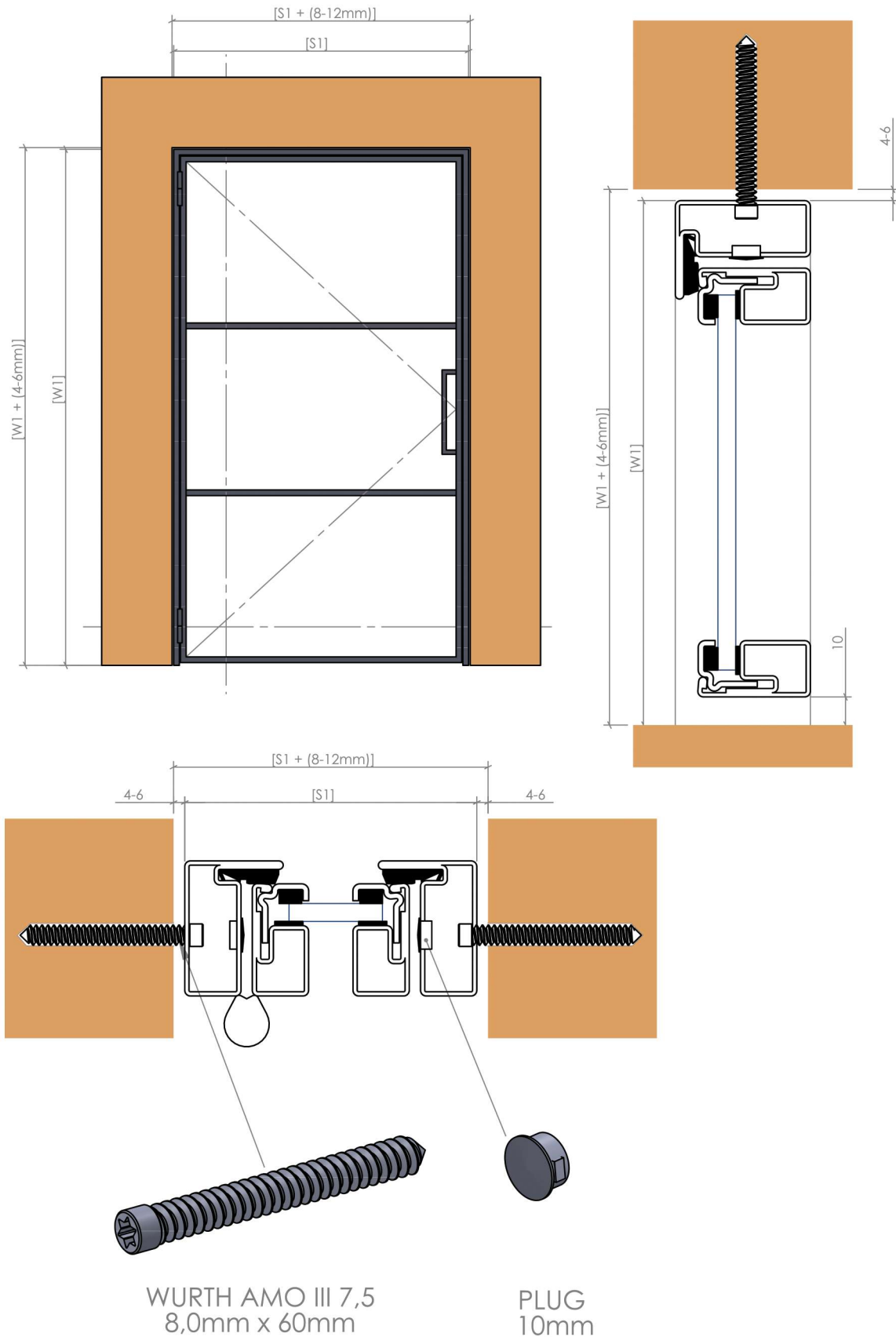

# HINGE DOOR WITH SIDE PANELS AND FANLIGHT - INSTALLATION

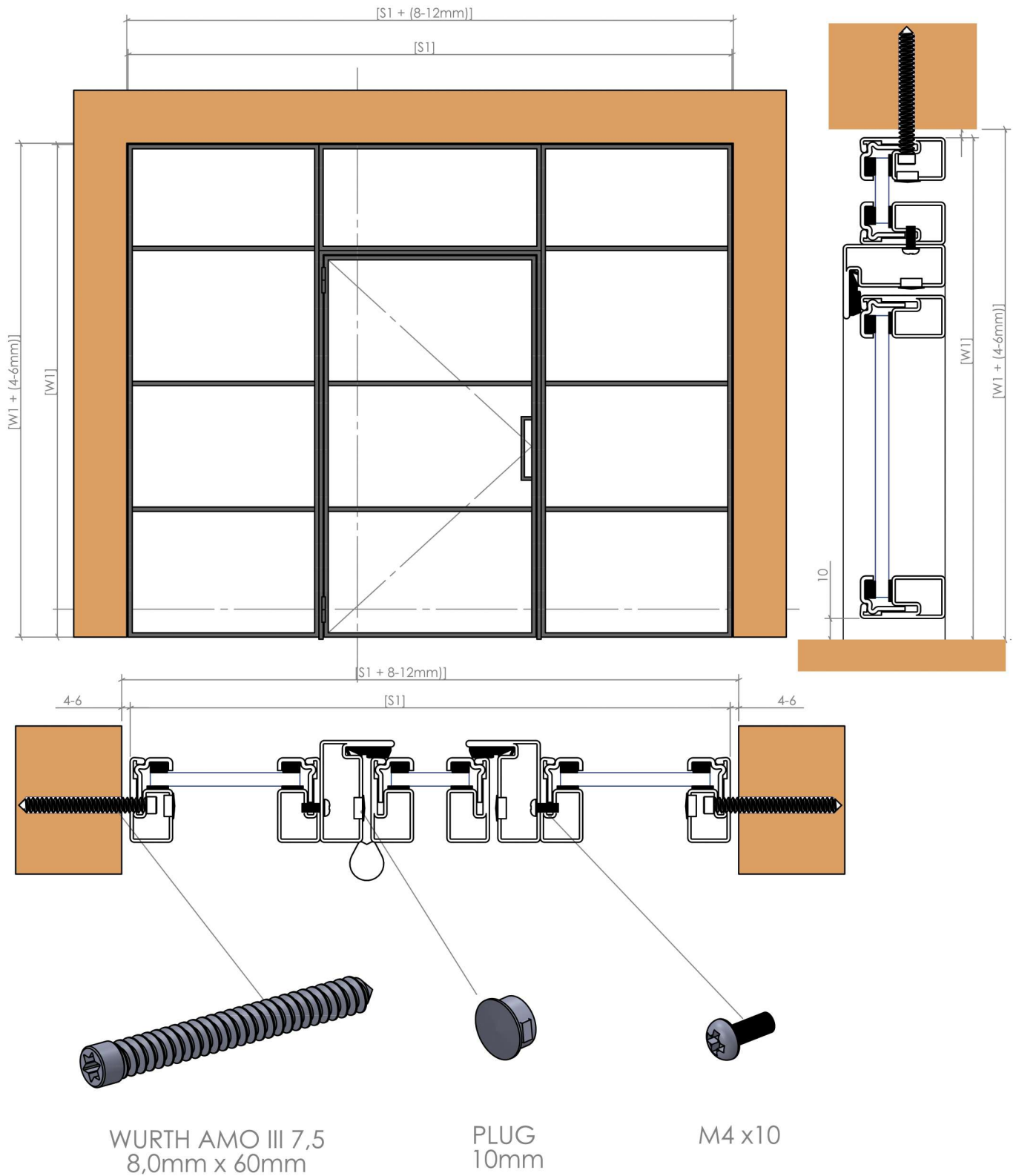

# CORNER GLASS WALL - ASSEMBLY

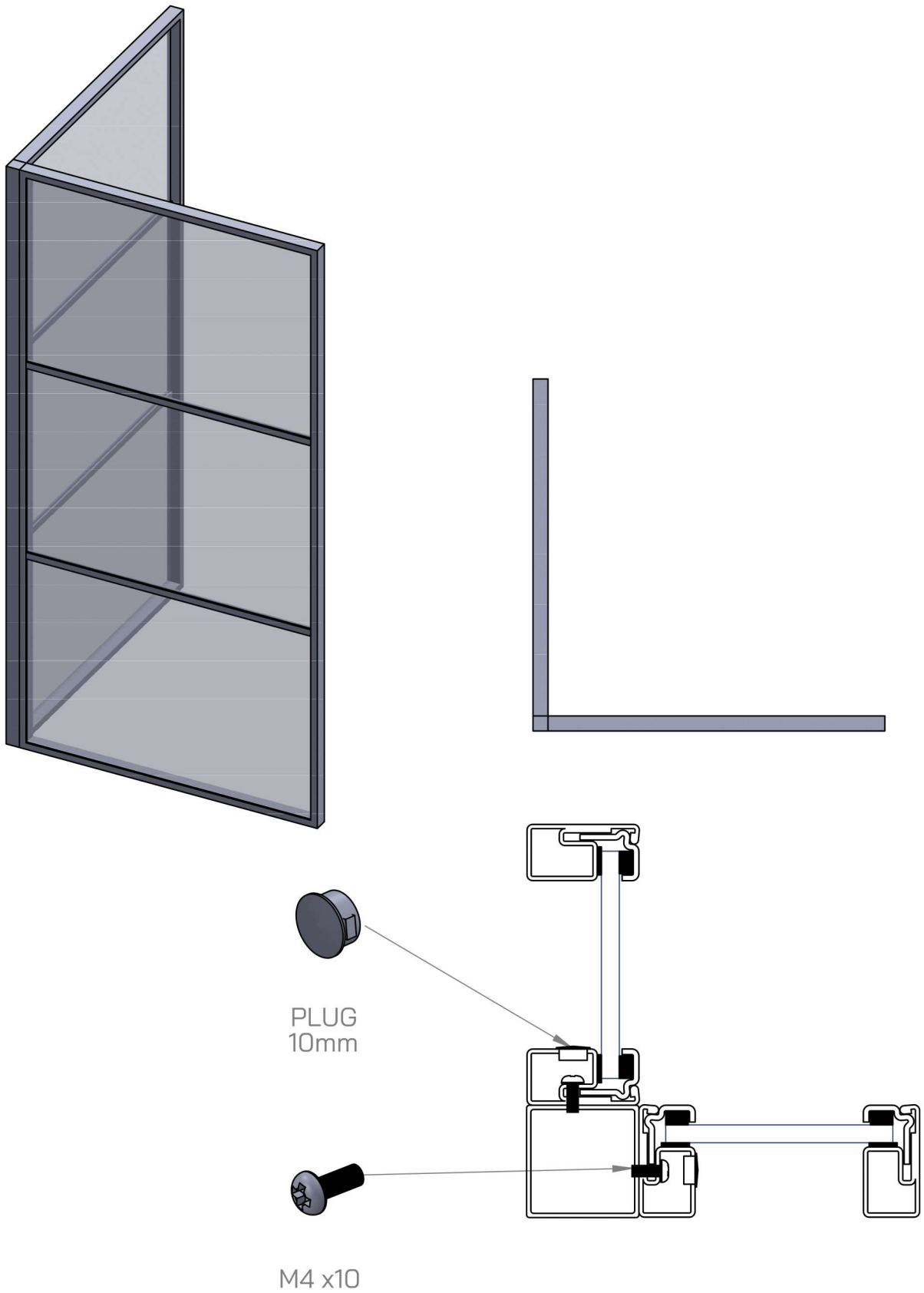

## GLASS TYPES



ESG PARSOL GRAY



ESG SATINOVO

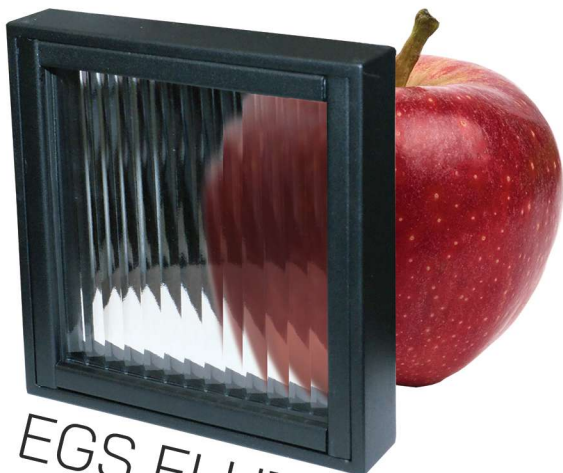

EGS FLUTES

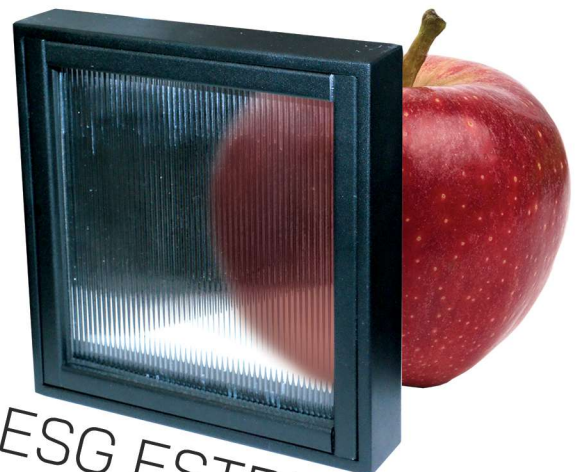

ESG ESTRIADO

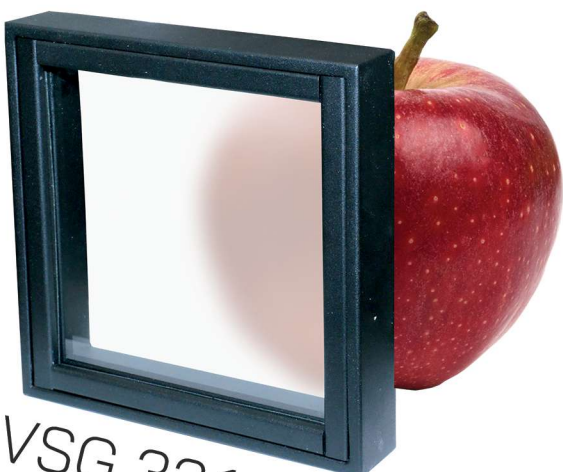

VSG 33.1 MAT



# SOLID WALLS

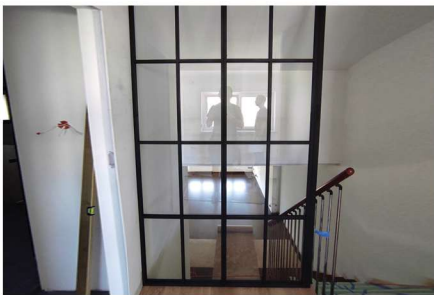

# ■ SINGLE HINGED DOORS

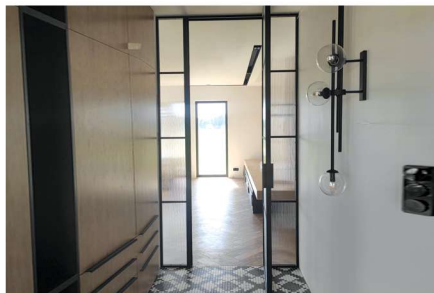
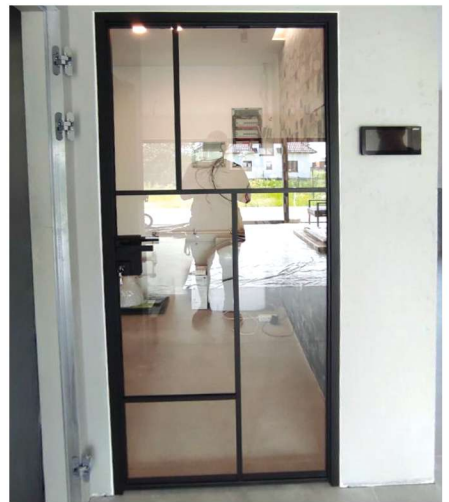
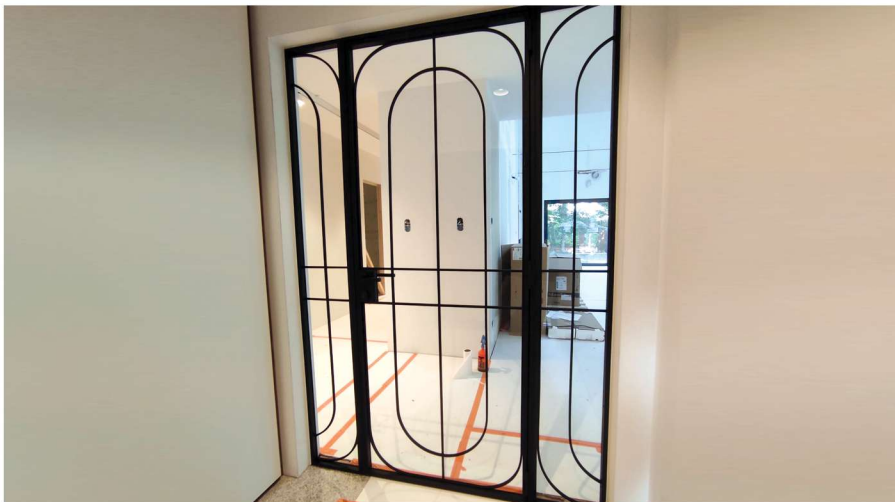

# DOUBLE HINGED DOORS

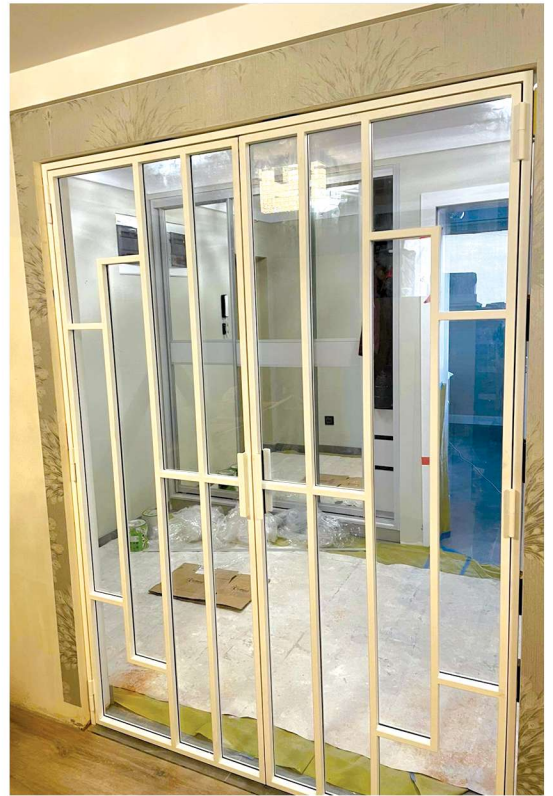



# HINGED DOOR KITS

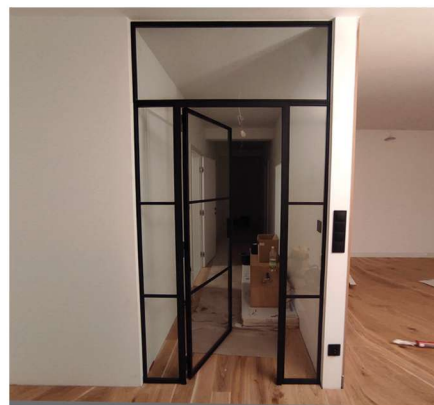
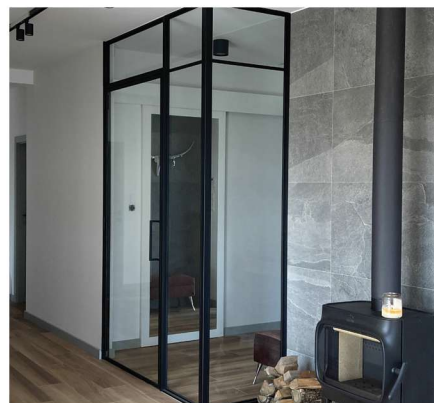

# SLIDING DOORS

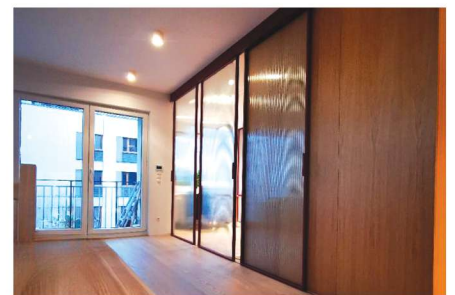

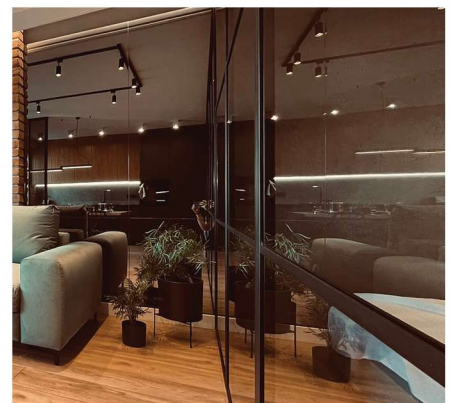
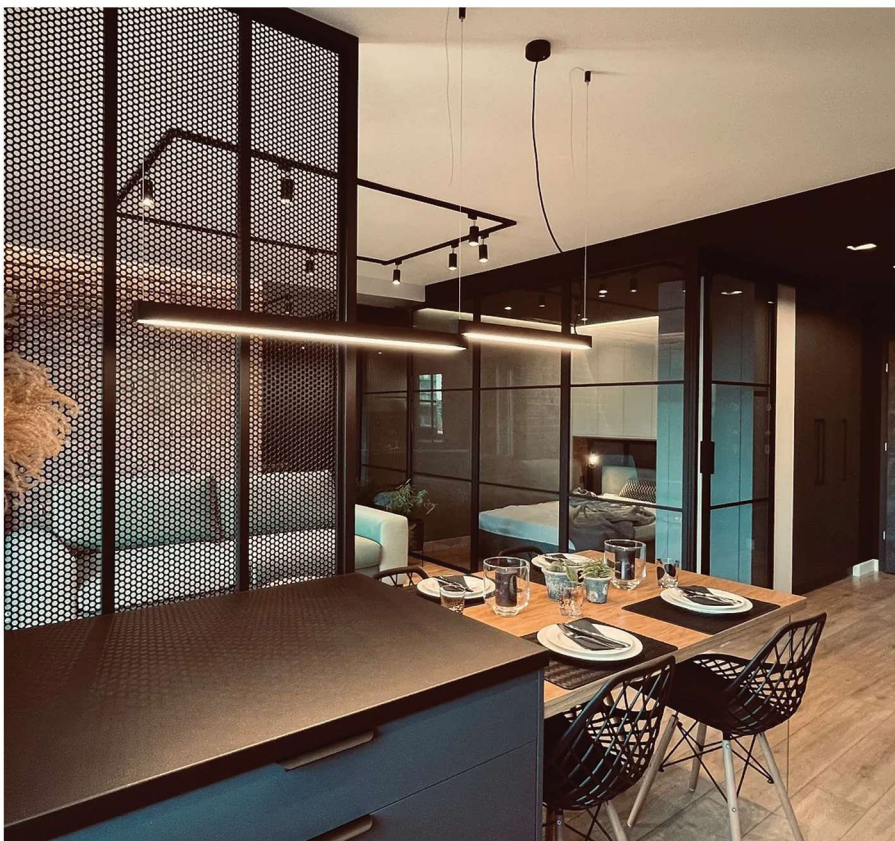

# FOLDING DOOR

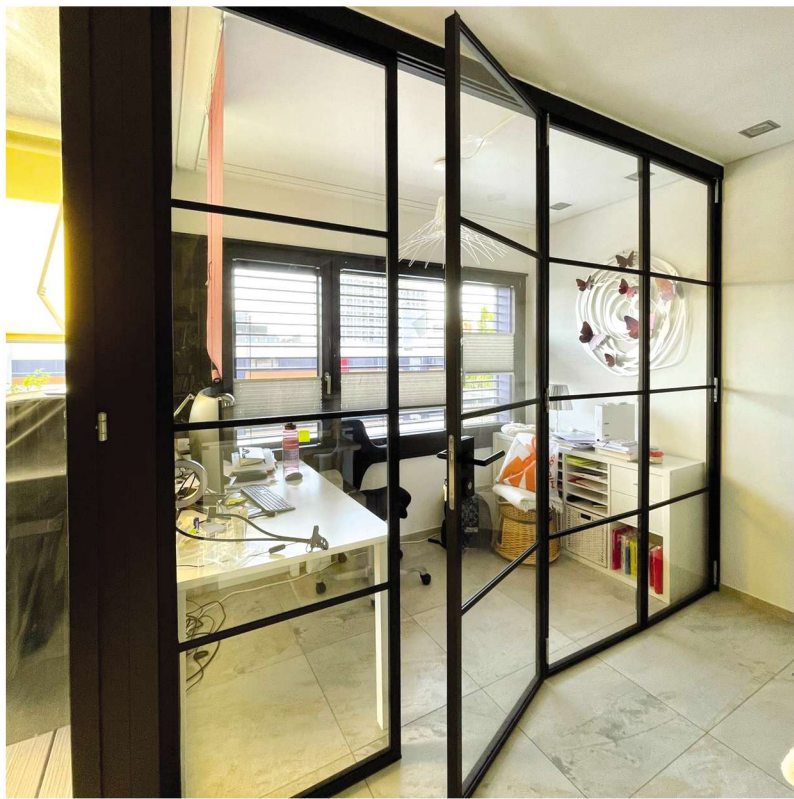

# GRIPS

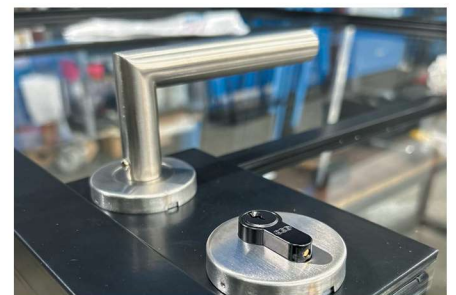

# PRODUCTION



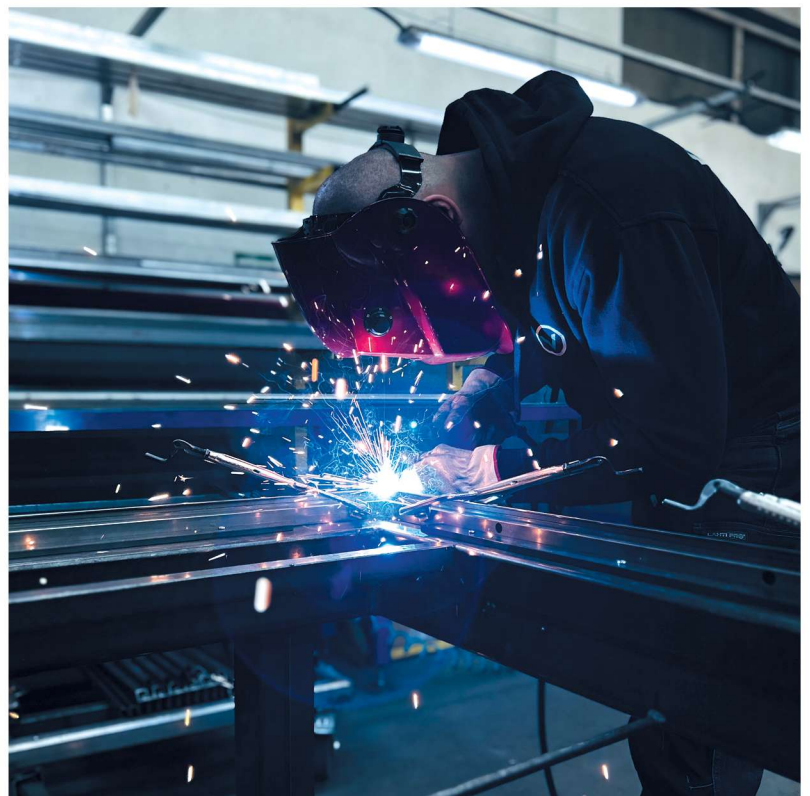
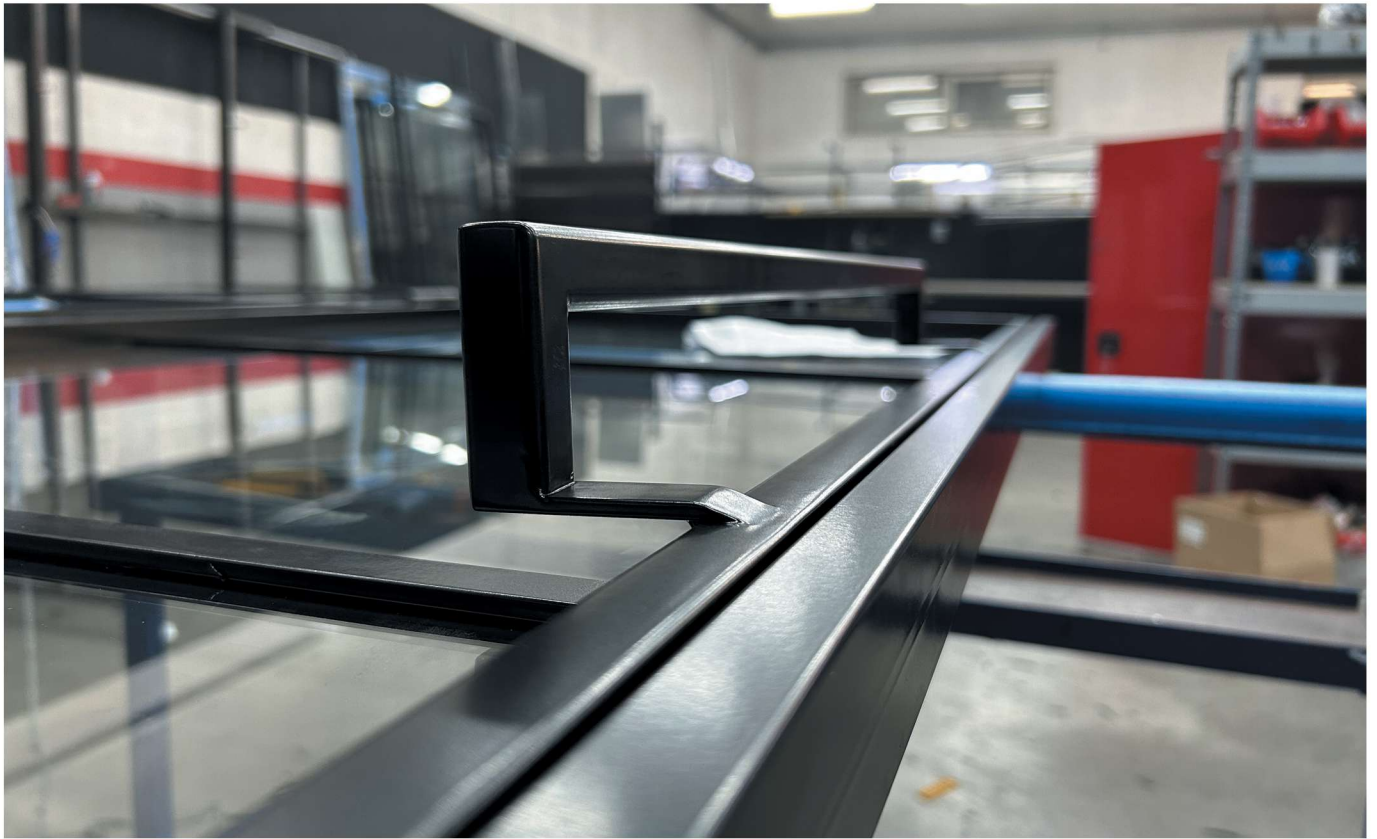

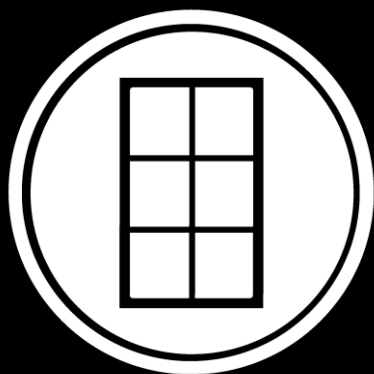

PGDOM  
INDUSTRIAL

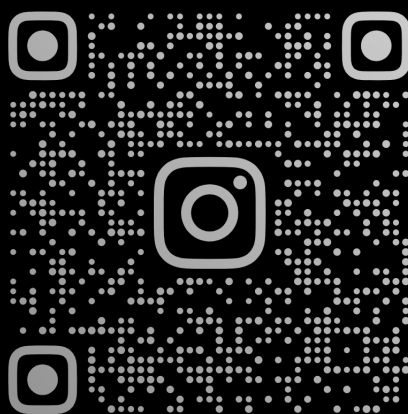

PGDOM\_INDUSTRIAL

PGDOM INDUSTRIAL

salon sprzedaży:

ul. 27 stycznia 2A 62-065 Grodzisk Wielkopolski

tel: 601 149 224

biuro@pgdom.pl | oferty@pgdom.pl

www.pgdom.pl